

X:\Active Projects\Kimley-Horn\Sarasota County Peace River PS 5 BIDSET\Drawings\PS PLAN VIEW.dwg, 4/24/2020 2:56:09 PM, dmsm

This document, together with the concepts and designs presented herein, is intended only for the specific purpose and client for which it was prepared. Reuse of and improper reliance on this document without written authorization and adaptation by Kimley-Horn and Associates, Inc. shall be without liability to Kimley-Horn and Associates, Inc.

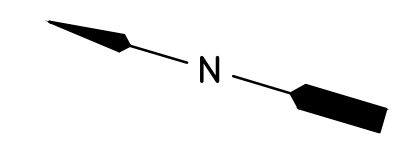
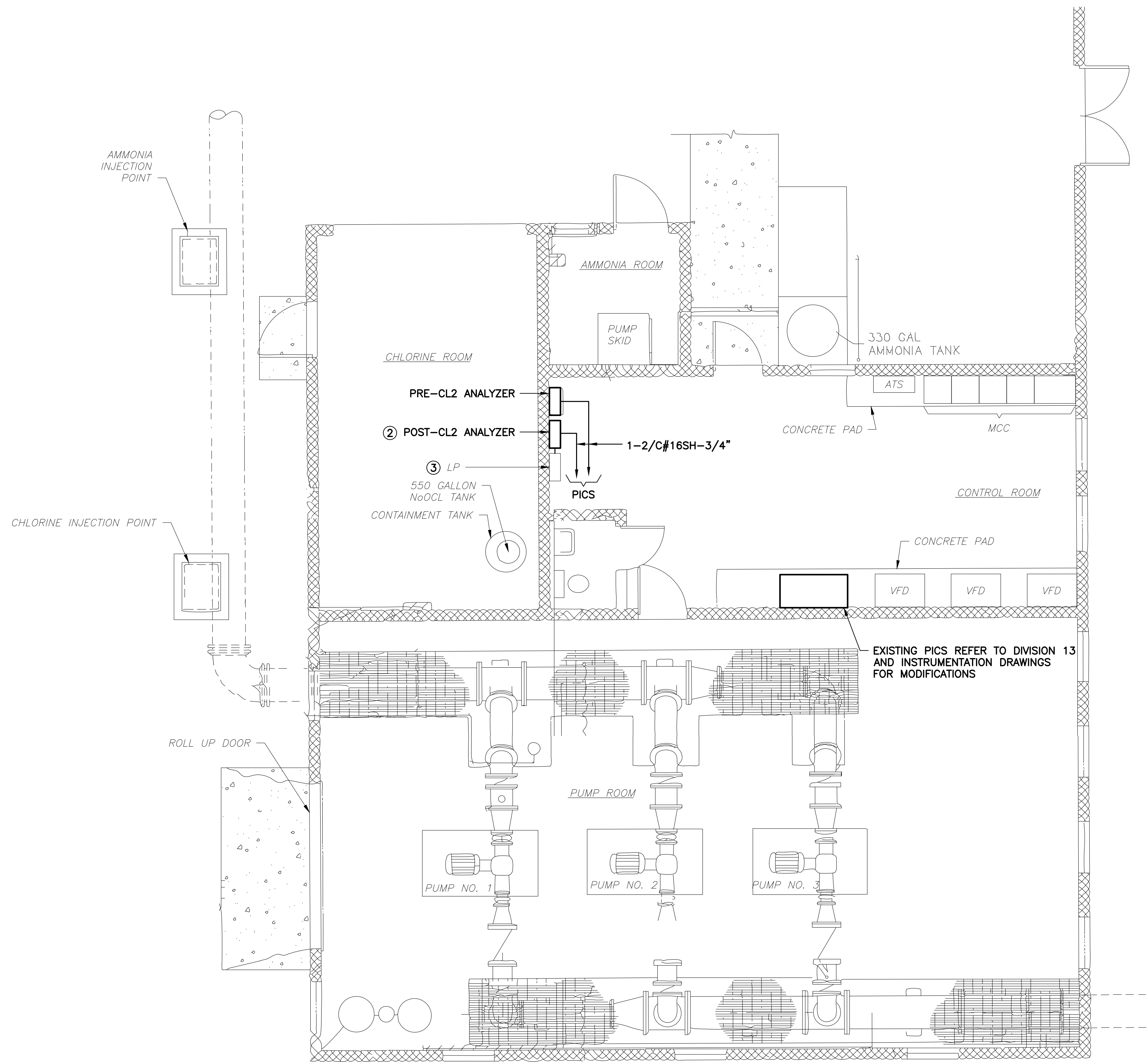

- NOTES:**
- ① CONNECT NEW PRE AND EXISTING POST SAMPLE LINES TO NEW CL2 ANALYZERS.
 - ② INSTALL NEW POST-CL2 ANALYZER AND CONFIRM OPERATION BEFORE REMOVING EXISTING CHEM SCAN ANALYZER.
 - ③ FURNISH AND INSTALL 120V, 20A, 1P BREAKERS IN EXISTING PANEL 'LP' FOR NEW ANALYZERS. PROVIDE 2#12 & 1#12 GND-3/4" FROM PANEL LP TO NEW ANALYZERS.

PUMP STATION ELECTRICAL POWER PLAN

SCALE: 1/4"=1'-0"
 1 0 1 2 3 7'

10620 GRIFFIN ROAD, SUITE 202
 COOPER CITY, FLORIDA 33328
 PHONE: (954) 448-7930
 C.O.A. NO. 6783
 Stephen E. Bailey, P.E.
 Florida P.E. No. 42461

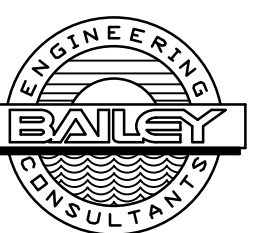

BIDSET SUBMITTAL

No.	REVISIONS	DATE	BY

Kimley»Horn
 1777 MAIN STREET, SUITE 200, SARASOTA, FL 34236
 PHONE: 941-379-7600
 WWW.KIMLEY-HORN.COM CA 00000696

KHA PROJECT	
DATE	4/24/20
SCALE:	AS NOTED
DESIGNED BY	SEB
DRAWN BY	SJL
CHECKED BY	SEB

Sarasota County
PEACE RIVER INTERCONNECT AND POTABLE WATER TRANSMISSION MAIN
 SARASOTA COUNTY

LICENSED PROFESSIONAL
 STEPHEN E. BAILEY, P.E.
 42461
 FL DATE:

**PUMP STATION NO. 5
 ELECTRICAL POWER PLAN**

SHEET NUMBER
E-04