

10/17/2014 10:50:43 AM - P:\IER\1740\200-11740-10003\CAD\SHEETFILES\TREATMENT PLANT\WTP-E-0102-E-0106 ELECTRICAL SITE PLAN SECTIONS.DWG - CALZARETTA, TIMOTHY

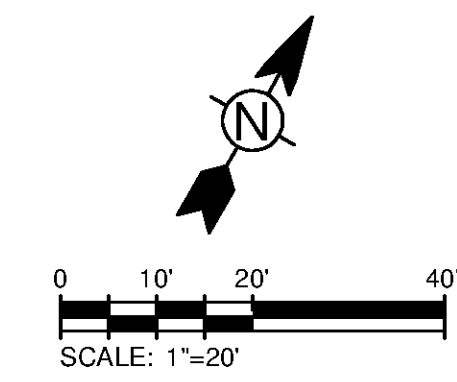
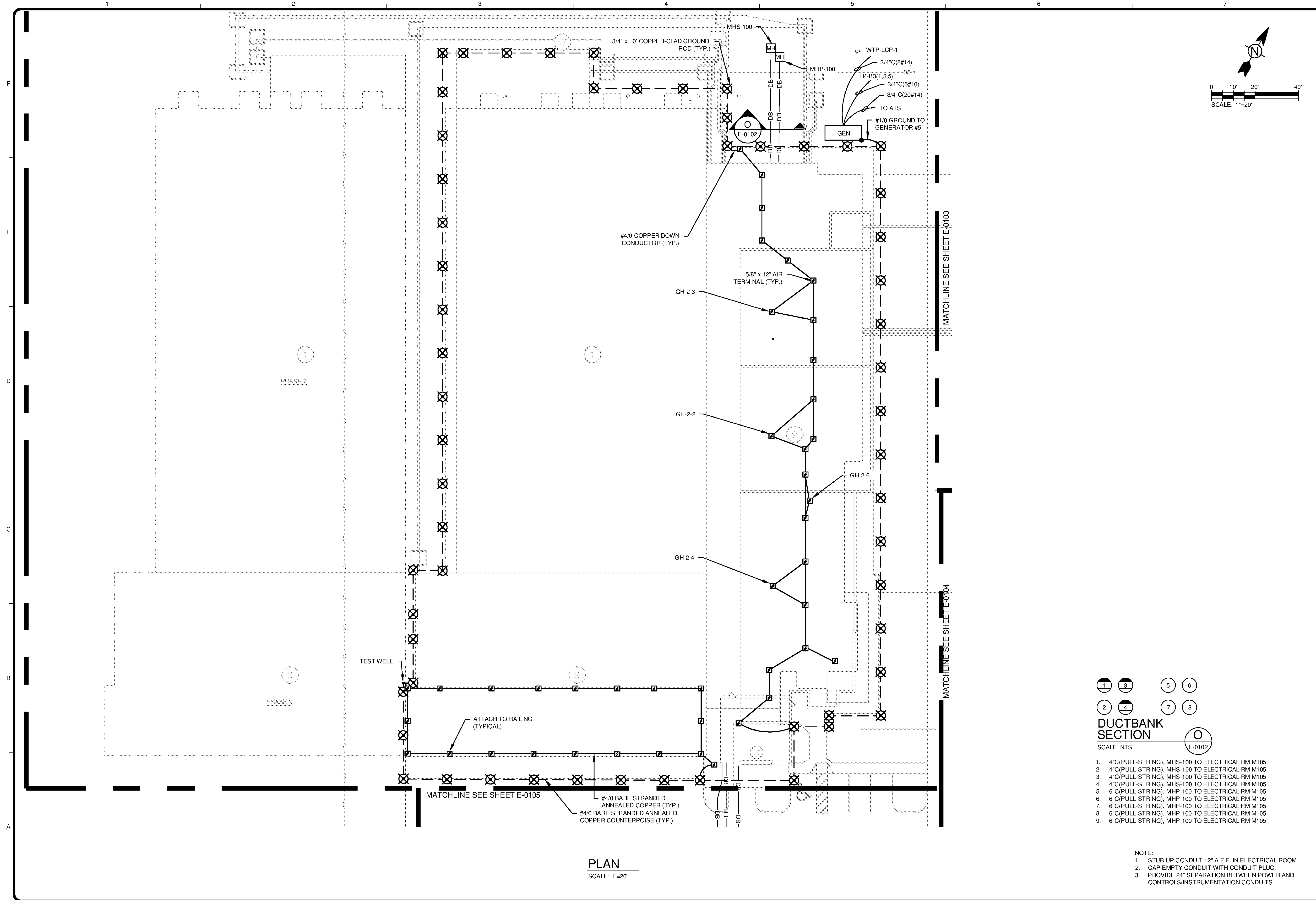

**PLAN**  
SCALE: 1"=20'

**DUCTBANK SECTION**  
 SCALE: NTS

- 4" (PULL-STRING), MHS-100 TO ELECTRICAL RM M105
- 4" (PULL-STRING), MHS-100 TO ELECTRICAL RM M105
- 4" (PULL-STRING), MHS-100 TO ELECTRICAL RM M105
- 4" (PULL-STRING), MHS-100 TO ELECTRICAL RM M105
- 6" (PULL-STRING), MHP-100 TO ELECTRICAL RM M105
- 6" (PULL-STRING), MHP-100 TO ELECTRICAL RM M105
- 6" (PULL-STRING), MHP-100 TO ELECTRICAL RM M105
- 6" (PULL-STRING), MHP-100 TO ELECTRICAL RM M105
- 6" (PULL-STRING), MHP-100 TO ELECTRICAL RM M105

- NOTE:
- STUB UP CONDUIT 12" A.F.F. IN ELECTRICAL ROOM.
  - CAP EMPTY CONDUIT WITH CONDUIT PLUG.
  - PROVIDE 24" SEPARATION BETWEEN POWER AND CONTROLS/INSTRUMENTATION CONDUITS.

**TETRA TECH**  
 www.tetrattech.com  
 101 QUALITY CIRCLE, SUITE 140  
 HUNTSVILLE, ALABAMA 35806  
 PHONE: (256) 424-4077 FAX: (256) 424-4097

BID SET

| MARK | DATE | DESCRIPTION | BY |
|------|------|-------------|----|
|      |      |             |    |
|      |      |             |    |
|      |      |             |    |
|      |      |             |    |
|      |      |             |    |
|      |      |             |    |
|      |      |             |    |
|      |      |             |    |
|      |      |             |    |
|      |      |             |    |

HUNTSVILLE UTILITIES  
 SOUTHEAST WATER TREATMENT PLANT  
**ELECTRICAL PLAN -  
 SITE SECTION A**

Project No.: 200-11740-10003  
 Designed By: CSW  
 Drawn By: TAC  
 Checked By: DAB

**E-0102**