

COLOR LIST					
ABBREVIATION	DESCRIPTION	MANUFACTURER	MODEL / PATTERN	COLOR	LOCATION
ACT-1	ACOUSTICAL CEILING TILE SYSTEM	ARMSTRONG	OPTIMA	WHITE	AS SCHEDULED
ADF-1	ALUMINUM PASSAGE DOOR FRAMES	KYNAR 500	PVDF RESIN BASE	SKY BLUE	ALL BUILDINGS
AF-1	ALUMINUM FINISH - ANODIZED ALUMINUM STOREFRONT MEDIUM BRONZE	KAWNEER	#28 MEDIUM BRONZE	AA-M10C22A44	CURTAIN WALL LOBBY OPS BLD
AL-1	DRAINABLE BLADE ARCHITECTURAL LOUVERS	GREENHECK	PVDF RESIN BASE	SKY BLUE	ALL BUILDINGS
BR-1	FACE BRICK	GENERAL SHALE	C652 RED CENTENNIAL	RED	ALL BUILDINGS
CJ-2	CONTROL JOINT SEALANT BRICK / CMU				MATCH BRICK COLOR
CP-1	COPING	KYNAR 500	PVDF RESIN BASE	SKY BLUE	
CTB-1	CERAMIC TILE BASE	AMERICAN OLEAN	SHADOW BAY	SH55 FISHING PIER	RESTROOM AND SHOWER ROOM
CTF-1	CERAMIC TILE FLOOR	AMERICAN OLEAN	SHADOW BAY	SH52 SEA GRASS	RESTROOMS AND SHOWER ROOM
CTG-1	CERAMIC TILE GROUT	LATICRETE	#40	LATTE	
CTW-1	CERAMIC TILE WALL	AMERICAN OLEAN	SHADOW BAY	SH52 SEA GRASS	
DS-1	DOWNSPOUTS				
ERC-1	EPOXY RESIN COUNTERTOP (LABS)	DURCON	CLASSICTOPS	BALCK ONYX	LAB A AND LAB B
FRP-1	FIBER REINFORCED PLASTIC DOORS	CLINE	PEBBLEGRAIN	BEIGE	EXTERIOR DOORS UNO
GFCMU-1	GROUND FACE CMU ACCENT BANDS	TRENYTH	TRENDSTONE	WILLIAMSBURG GREY	ACCENT BANDS ALL BUILDINGS
H-1/S	HARDENER / SEALER				
HWS-1	HORIZONTAL WINDOW SHADES	HUNTER DOUGLAS	CD82	002 ALABASTER	PER NOTE 4 BELOW
LK-1	LOCKERS	PENCO	073	CHAMPAGNE	
MM-1	MASONRY MORTAR	MASONRY MORTAR	BRIXMENT	OC OLD COLONIAL	ALL EXTERIOR CLAY MASONRY WALLS AND OPS LOBBY INTERIOR CLAY MASONRY
PC-1	PAINT COLOR 1 BASE COLOR	SHERMAN WILLIAMS	SW0050	CLASSIC LIGHT BUFF	ALL INTERIOR WALLS UNO
PC-2	PAINT COLOR 2 HM DOOR FRAMES	SHERMAN WILLIAMS	SW 0037	MORRIS ROOM GREY	INTERIOR HM DOORS & FLOOR PAINT
PC-3	PAINT COLOR 3 INTERIOR HM DOORS AND ACCENT WALLS	SHERMAN WILLIAMS	SW 0042	RUSKIN ROOM GREEN	INTERIOR HM DOOR FRAMES & ACCENT WALL AS NOTED
PC-4	PAINT COLOR 4 CEILINGS	SHERMAN WILLIAMS	SW 7757	HIGH REFLECTIVE WHITE	CEILINGS UNO
PL-1	PLASTIC LAMINATE	WILSONART	PREMIUM AEON	4861K-07 GOLD ALCHEMY	ABOVE BACKSPLASHES / BELOW UPPER CABINETS
PL-2	PLASTIC LAMINATE CASEWORK IN LABS	FORMICA	MATTE FINISH 58	800 ARTIHOKE	
PL-3	PLASTIC LAMINATE CASEWORK IN BREAKROOM	FORMICA	MATTE FINISH 58	8846 OILED LEGNO	
RB-1	ROPPE 191 CAMEL / VISUELLE	ROPPE	191	CAMEL/VISUELLE	
SS-1	SOLID SURFACING (BREAKROOM)	DUPONT CORIAN		DOVE	BREAKROOM COUNTER / WINDOW SILLS
SS-2	SOLID SURFACING (SHOWER WALLS)	DUPONT CORIAN		DOESKIN	SHOWER STALL WALLS
SS-3	SOLID SURFACING WINDOW SILLS	DUPONT CORIAN		MEDEA	WINDOW SILLS
SSMR-1	STANDING SEAM METAL ROOF	FIRESTONE KYNAR 500	PVDF RESIN BASE	SKYBLUE SR	
ST-1	STAIN COLOR 1 WOOD CASEWORK IN LABS AND SCW DOORS	CABOT	WOOD STAIN	RED MAHOGANY	SCW DOORS AND LAB CASEWORK
TER-1	TERRAZZO NATIONAL TERRAZZO AND MOSAIC ASSOCIATION NO EP2-58	NTMA	EP 2-58		AS SCHEDULED
TP-1	TOILET PARTITION	BRADLEY	PHENOLIC SERIES 500	032F NATURE SOLIDZ	TOILET PARTITION
VCT-1	VINYL COMPOSITION TILE	ARMSTONG	EXCELON IMPERIAL TEXTURE	51804 EARTHSTONE GREIGE	

- NOTES:
- THE GENERAL CONTRACTOR SHALL PERPREARE COLOR SAMPLES OF MATERIALS FOR APPROVAL BY ONWER PRIOR TO ORDERING MATERIALS.
 - ALL COLORS SHALL BE SELECTED FROM THE MANUFACTURER'S STANDARD COLOR PALLET U.N.O.
 - SEE LISTED MANUFACTURER NOTE FOR ADDITIONAL INFORMATION REGARDING COLOR AND FINISH LISTS.
 - PROVIDE HORIZONTAL ALUMINUM BLINDS IN ALL 4X4 WINDOWS IN LABS, TRAINING ROOM, BREAK ROOM, RESTROOM AND SUPPLY ROOM (TYP OF 10) AND 8X8 WINDOW IN OFFICE

LISTED MANUFACTURER NOTE:

MANUFACTURERS ARE REFERENCED TO ESTABLISH STYLE, SIZE, COLOR AND MATERIAL CHARACTERISTICS AND ARE NOT INTENDED TO LIMIT SELECTIONS FROM OTHER MANUFACTURERS. WHEN AN ALTERNATE SELECTION IS SUBMITTED, SUBMITTALS SHALL HAVE INCLUDED THE MATERIAL LISTED FOR COMPARISON.

FOR PURPOSE OF COLOR CONSISTANCY - KYNAR 500 SKY BLUE EQUALS FEDERAL STANDARD 595 COLOR 25183.

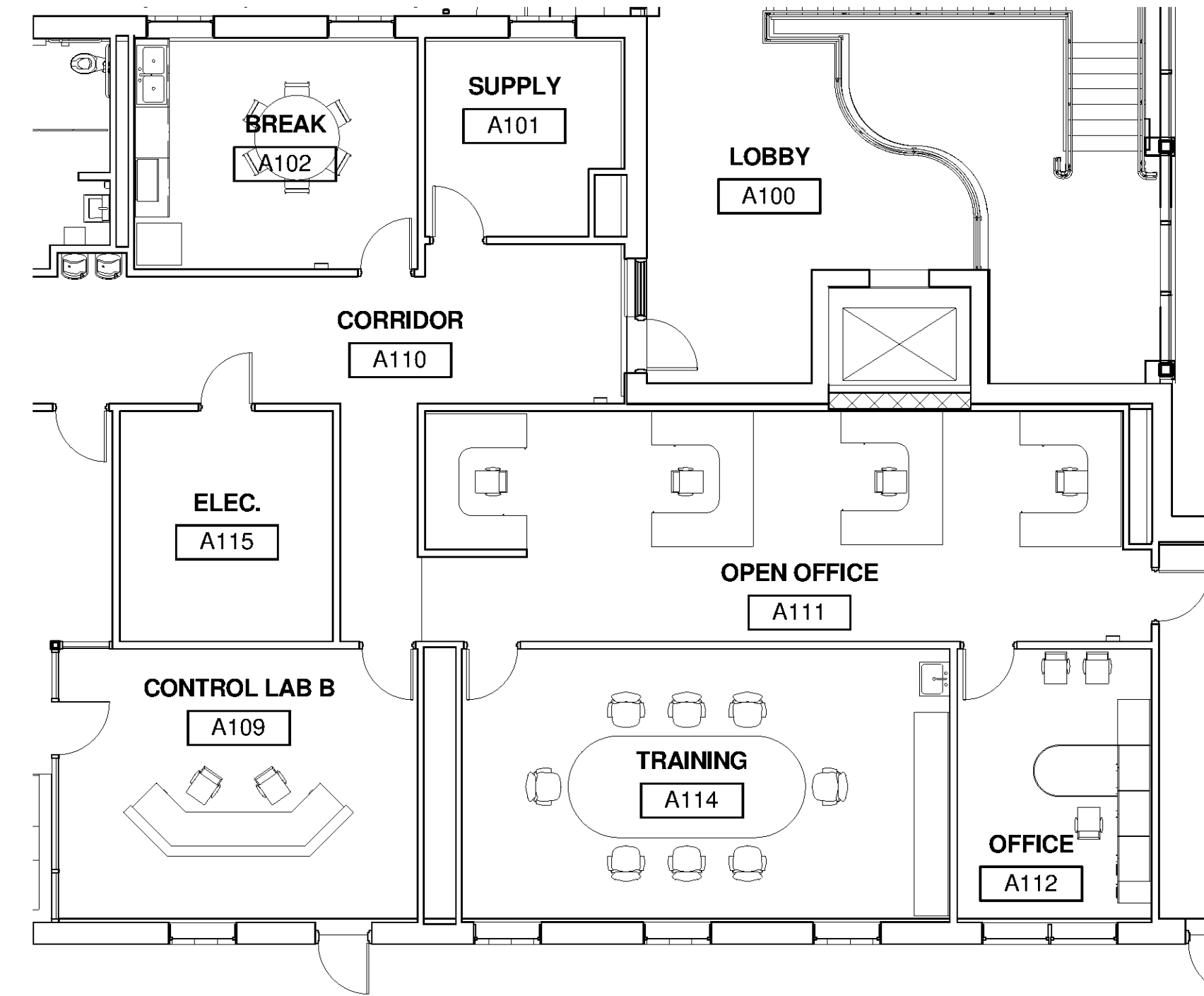

FURNITURE PLAN

SCALE: 1/8" = 1'-0"

FURNITURE PLAN INCLUDED FOR COORDINATION PURPOSES WITH ELECTRICAL, LIGHTING, DATA, AND COMMUNICATION

ROOM SCHEDULE									
NUMBER	NAME	FLOOR FINISH	FLOOR COLOR	BASE FINISH	BASE COLOR	WALL FINISH	WALL COLOR	CEILING	COMMENTS
A100	LOBBY	TERRAZZO	TER-1	TERRAZZO	TER-1	EXPOSED MASONRY	AF-1, BR-1, GFCMU-1, PC-1, PC-3	ACT, GWB	GWB AT BASE OF CURTAINWALL PC-3
A101	SUPPLY	VINYL COMPOSITION TILE	VCT-1	RESILIENT	RB-1	PAINT	PC-1	ACT	
A102	BREAK	VINYL COMPOSITION TILE	VCT-1	RESILIENT	RB-1	PAINT	PC-1, PC-3 ACCENT WALL	ACT	SEE SHEET A-9604 FOR ACCENT WALL LOCATIONS
A103	RESTROOM	CERAMIC TILE FLOOR	CTF-1	CERAMIC TILE	CTB-1	CERAMIC TILE WALL	CTW-1	MR GWB	
A104	JANITOR	VINYL COMPOSITION TILE	VCT-1	RESILIENT	RB-1	PAINT	PC-1	ACT	
A105	SHOWER	CERAMIC TILE FLOOR	CTF-1	CERAMIC TILE	CTB-1	CERAMIC TILE WALL	CTW-1, SS-2	MR GWB	
A106	LOCKERS	CERAMIC TILE FLOOR	CTF-1	CERAMIC TILE	CTB-1	PAINT	PC-1	GWB	
A107	SUPPLY	VINYL COMPOSITION TILE	VCT-1	RESILIENT	RB-1	PAINT	PC-1	ACT	
A108	CONTROL LAB A	TERRAZZO	TER-1	TERRAZZO	TER-1	PAINT	PC-1, PC-3 ACCENT WALL	ACT	
A109	CONTROL LAB B	TERRAZZO	TER-1	TERRAZZO	TER-1	PAINT	PC-1, PC-3 ACCENT WALL	ACT	
A110	CORRIDOR	TERRAZZO	TER-1	TERRAZZO	TER-1	PAINT	PC-1	ACT	
A111	OPEN OFFICE	TERRAZZO	TER-1	TERRAZZO	TER-1	PAINT	PC-1, PC-3 ACCENT WALL	ACT	
A112	OFFICE	VINYL COMPOSITION TILE	VCT-1	RESILIENT	RB-1	PAINT	PC-1, PC-3 ACCENT WALL	ACT	
A113	STAIRS	VINYL COMPOSITION TILE	VCT-1	RESILIENT	RB-1	PAINT	PC-1, PC-3 ACCENT WALL	ACT	
A114	TRAINING	TERRAZZO	TER-1	TERRAZZO	TER-1	PAINT	PC-1, PC-3 ACCENT WALL	ACT	
A115	ELEC.	VINYL COMPOSITION TILE	VCT-1	RESILIENT	RB-1	PAINT	PC-1	ACT	
C100	HYDROCHLORITE ROOM	CONCRETE PAINT - SYSTEM 21	EPOXY	RESILIENT	RB-1	PAINT	PC-1 SYSTEM 22	PAINT	SEE SECTION 09 90 00 FOR PAINTING SYSTEMS
C101	ALUM ROOM	CONCRETE PAINT - SYSTEM 21	EPOXY	RESILIENT	RB-1	PAINT	PC-1 SYSTEM 22	PAINT	
C102	FLUORIDE METERING PUMPS	CONCRETE PAINT - SYSTEM 21	EPOXY	RESILIENT	RB-1	PAINT	PC-1 SYSTEM 22	PAINT	
C103	FLUORIDE	CONCRETE PAINT - SYSTEM 21	EPOXY	RESILIENT	RB-1	PAINT	PC-1 SYSTEM 22	PAINT	
C104	POLYMER & SODIUM THIOSULFATES	CONCRETE PAINT - SYSTEM 21	EPOXY	RESILIENT	RB-1	PAINT	PC-1 SYSTEM 22	PAINT	
C105	STAIRS	CONCRETE PAINT - SYSTEM 21	EPOXY	RESILIENT	RB-1	PAINT	PC-1 SYSTEM 22	NONE	
M100	VESTIBULE	TERRAZZO	TERRAZZO	TERRAZZO	TER-1	STOREFRONT	AF-1, PC-1, PC-3	ACT	
M101	LOBBY	TERRAZZO	TERRAZZO	TERRAZZO	TER-1	STOREFRONT	AF-1, BR-1, GFCMU-1, PC-1, PC-3	ACT	
M102	MECH. ELEV	CONCRETE PAINT - SYSTEM 21	EPOXY	RESILIENT	RB-1	PAINT	PC-1	NONE	
M103	CORRIDOR	CONCRETE PAINT - SYSTEM 21	EPOXY	RESILIENT	RB-1	PAINT	PC-1	NONE	
M104	RESTRM	CONCRETE PAINT - SYSTEM 21	EPOXY	RESILIENT	RB-1	PAINT	PC-1	NONE	
M105	ELECTRICAL	CONCRETE PAINT - SYSTEM 21	EPOXY	RESILIENT	RB-1	PAINT	PC-1	NONE	
M106	STAIRS	CONCRETE PAINT - SYSTEM 21	EPOXY	RESILIENT	RB-1	PAINT	PC-1	NONE	
M109	MAINTENANCE	CONCRETE PAINT - SYSTEM 21	EPOXY	RESILIENT	RB-1	PAINT	PC-1	NONE	
M110	PARTS	CONCRETE PAINT - SYSTEM 21	EPOXY	RESILIENT	RB-1	PAINT	PC-1	NONE	
M111	MAINT. STORAGE	CONCRETE PAINT - SYSTEM 21	EPOXY	RESILIENT	RB-1	PAINT	PC-1	NONE	
M112	GENERATOR	CONCRETE PAINT - SYSTEM 21	EPOXY	RESILIENT	RB-1	PAINT	PC-1 SYSTEM 22	NONE	
M-108	CORRIDOR	CONCRETE PAINT - SYSTEM 21	EPOXY	RESILIENT	RB-1	PAINT	PC-1	NONE	
P100	BLOWER ROOM	CONCRETE PAINT - SYSTEM 21	EPOXY	RESILIENT	RB-1	PAINT	PC-1 SYSTEM 22	NONE	
P101	PIPE GALLERY	CONCRETE PAINT - SYSTEM 21	EPOXY	RESILIENT	RB-1	PAINT	PC-1 SYSTEM 22	NONE	

WINDOW SCHEDULE

MARK	MANUFACTURER	MODEL	DESCRIPTION	HEIGHT	WIDTH	THICKNESS	FRAME TYPE	FRAME FINISH	GLAZING	COMMENTS
W1	Kawneer	AA 3350 AW 50 FP	Isopot Fixed Panel	4' - 0"	4' - 0"	0' - 3 1/2"	S	Aluminum ASTM B 221 - 6063 - T6	INSULATED GLASS	KYNAR 500 SKYBLUE
W3	Kawneer	AA 3350 AW 50 FP	Isopot Fixed Panel	6' - 0"	4' - 0"	0' - 3 1/2"	S	Aluminum ASTM B 221 - 6063 - T6	INSULATED GLASS	KYNAR 500 SKYBLUE
W4				4' - 0"	3' - 4"					

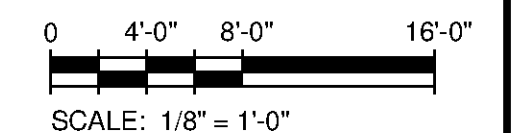

TETRA TECH



BID SET

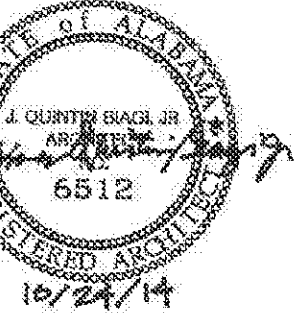

10/24/14

BY

DESCRIPTION

DATE

MARK

HUNTSVILLE UTILITIES
SOUTHEAST WATER TREATMENT PLANT

Project No.: 200-11740-10003
Designed By: Q.BIAGI
Drawn By: S.SWEARER
Checked By: D.GALANTE

A-2602

Bar Measures 1 inch