

10/1/2014 3:11:36 PM C:\Users\brent.fox\Documents\WTP-11740-S-WASHBA\_brent.fox.rvt

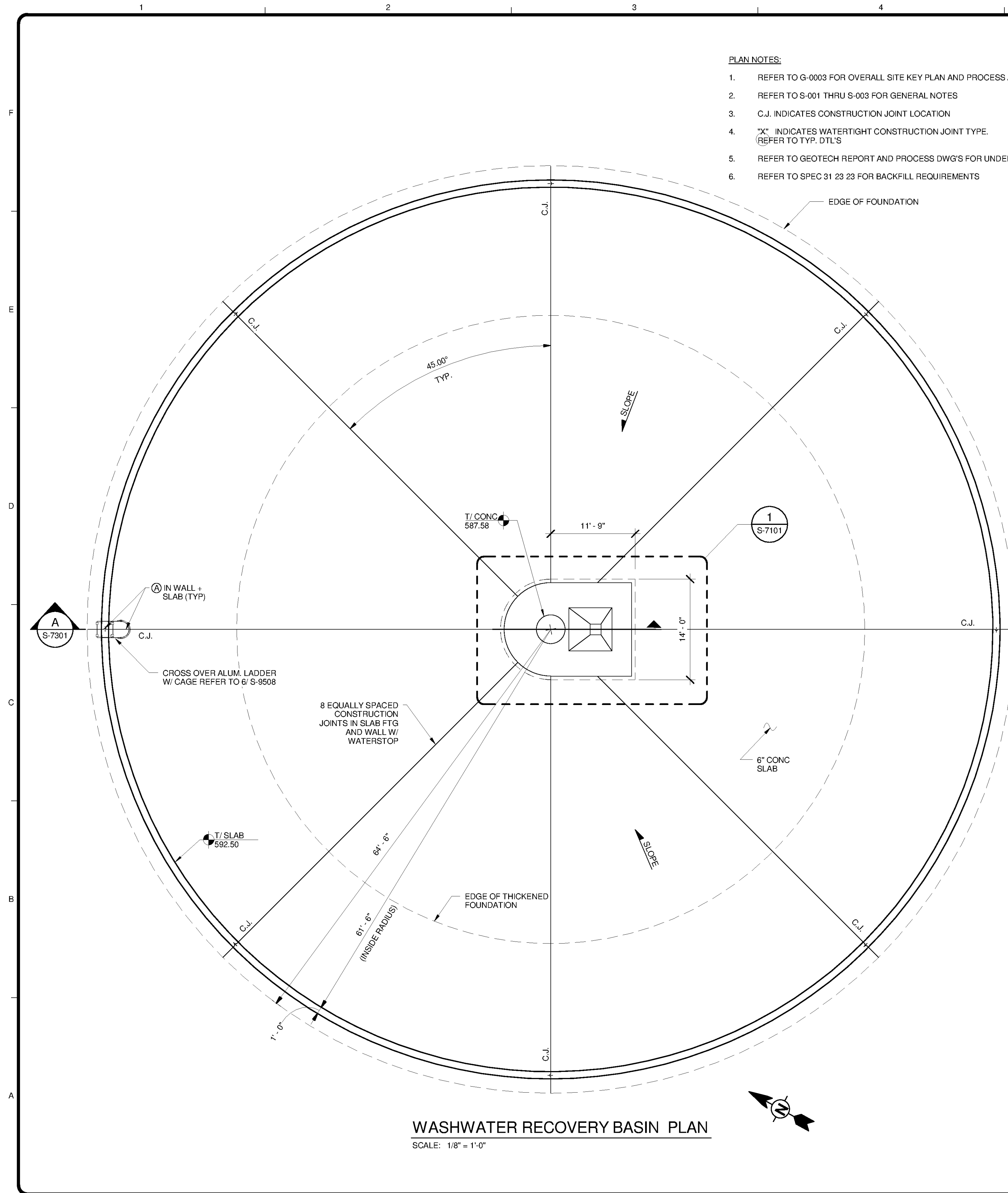

**WASTEWATER RECOVERY BASIN PLAN**  
SCALE: 1/8" = 1'-0"

- PLAN NOTES:**
1. REFER TO G-0003 FOR OVERALL SITE KEY PLAN AND PROCESS ASSIGNATIONS
  2. REFER TO S-001 THRU S-003 FOR GENERAL NOTES
  3. C.J. INDICATES CONSTRUCTION JOINT LOCATION
  4. "X" INDICATES WATERTIGHT CONSTRUCTION JOINT TYPE. (REFER TO TYP. DTL'S)
  5. REFER TO GEOTECH REPORT AND PROCESS DWG'S FOR UNDERDRAINS
  6. REFER TO SPEC 31 23 23 FOR BACKFILL REQUIREMENTS

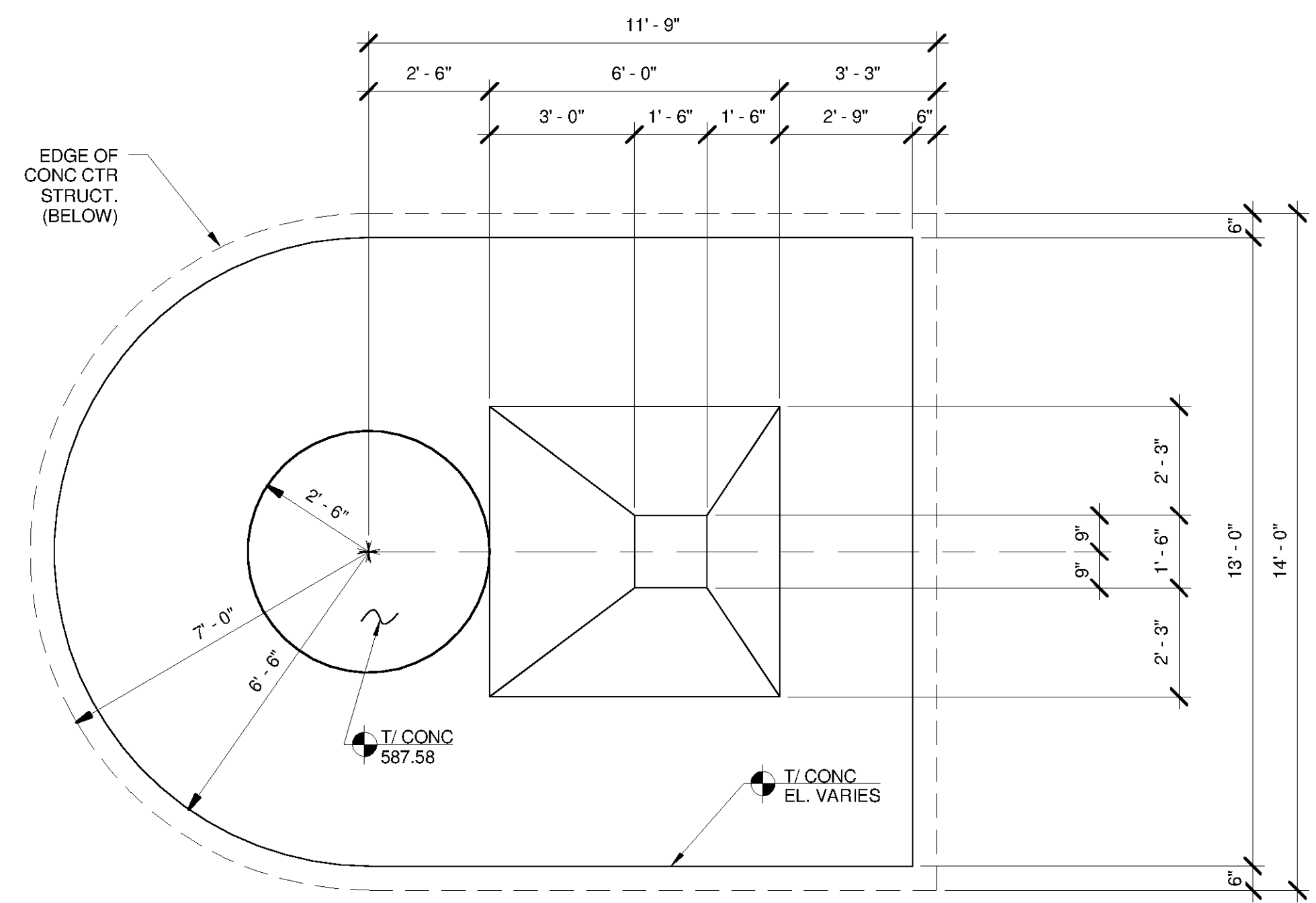

**1 ENLARGED DETAIL**  
S-7101 SCALE: 3/8" = 1'-0"

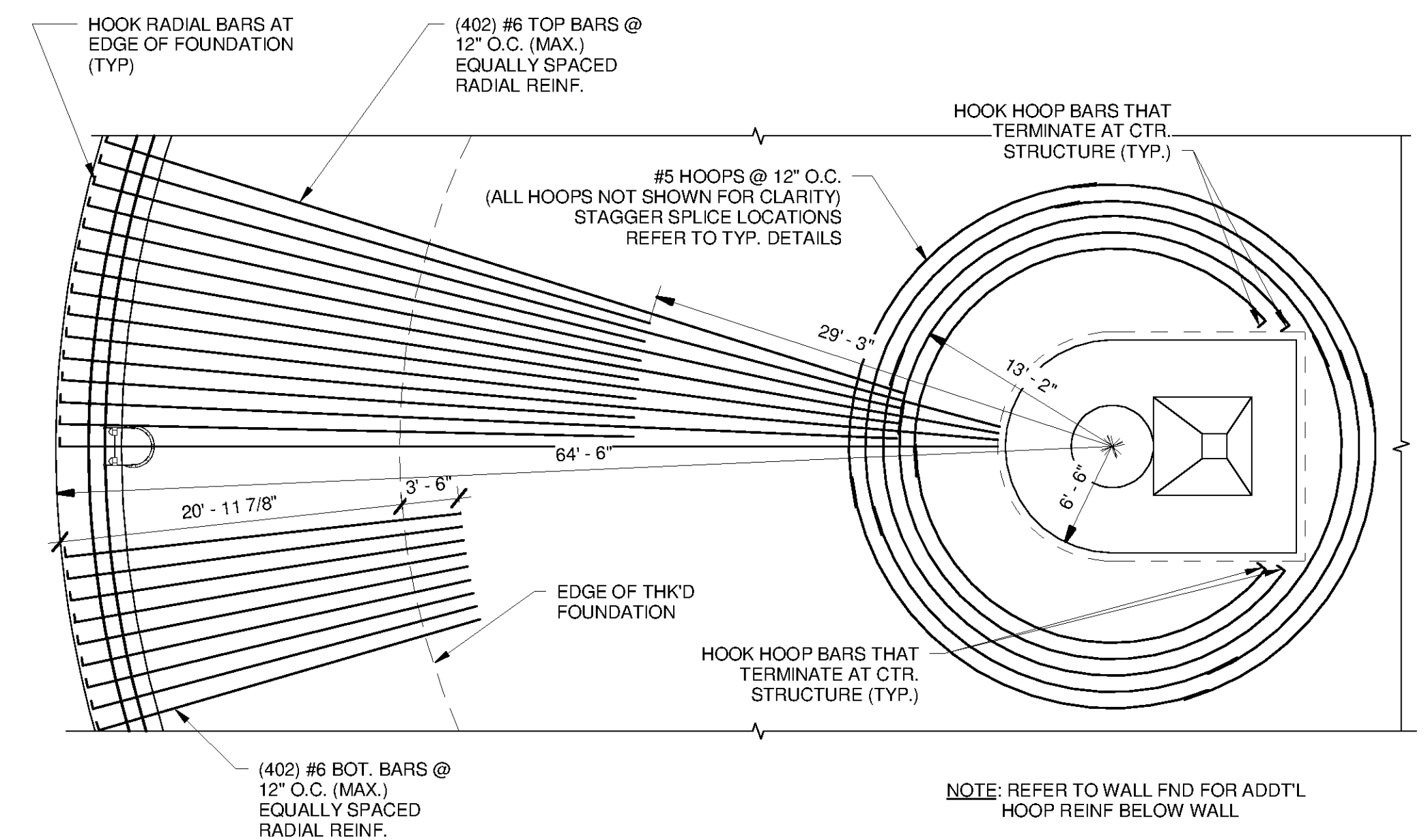

**2 SLAB REINFORCEMENT**  
S-7301 SCALE: 1/8" = 1'-0"

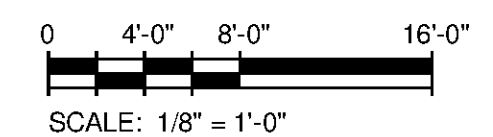

BID SET

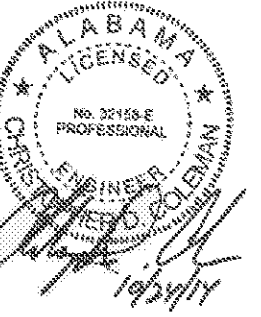

MARK	DATE	DESCRIPTION	BY

HUNTSVILLE UTILITIES  
SOUTHEAST WATER TREATMENT PLANT  
**WASTEWATER RECOVERY  
BASIN FOUNDATION PLAN**

Project No.: 200-11740-10003  
Designed By: JLB  
Drawn By: BRF  
Checked By: CDC

**S-7101**

Bar Measures 1 Inch

Copyright Tetra Tech