

1 2 3 4 5 6 7

F
E
D
C
B
A

MATCHLINE STA: 905+00

MATCHLINE STA: 912+50

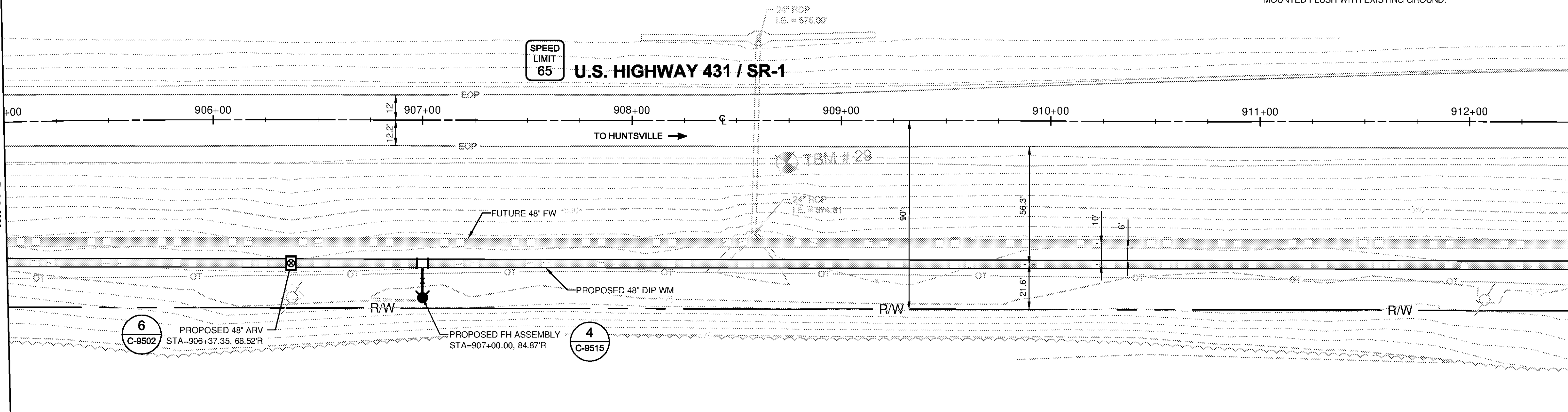

- NOTES:**
1. ALL DISTURBED AREAS SHALL BE RESODDED OR SEEDING IN ACCORDANCE WITH THE LATEST ALDOT SPECIFICATIONS FOR GRASSING OR AS DIRECTED BY THE DEPARTMENT OF TRANSPORTATION'S DISTRICT MANAGER.
 2. ALL TRAFFIC CONTROL SHALL BE IN ACCORDANCE WITH THE MOST CURRENT EDITION OF PART 6 OF THE MANUAL ON UNIFORM TRAFFIC CONTROL DEVICES (MUTCD).
 3. THE UTILITY AGREES TO ABIDE BY AND FOLLOW THE GUIDELINES SET FORTH IN THE ALABAMA HANDBOOK FOR EROSION CONTROL AND STORM WATER MANAGEMENT ON CONSTRUCTION SITES AND URBAN AREAS.
 4. ALL MANHOLES, VALVE BOXES, AND HANDHOLES SHOULD BE MOUNTED FLUSH WITH EXISTING GROUND.

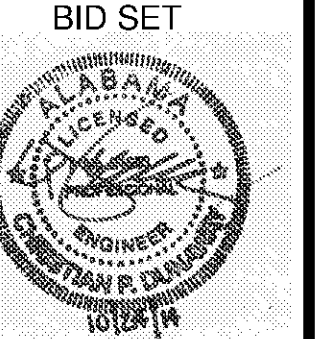
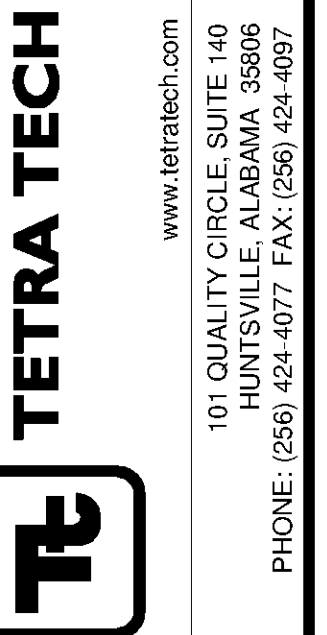
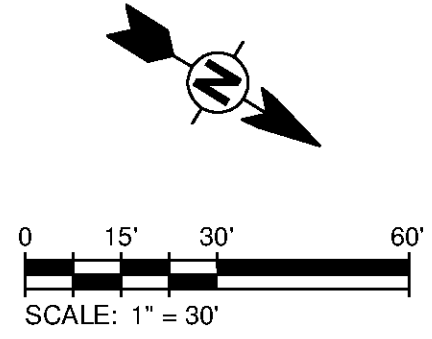

BID SET

MARK	DATE	DESCRIPTION

HUNTSVILLE UTILITIES
SOUTHEAST WATER TREATMENT PLANT
**FINISHED WATER MAIN
PLAN AND PROFILE**
STA 905+00 TO 912+50

Project No.: 200-11740-10003
Designed By: DNL
Drawn By: WDW
Checked By: JPT

C-2027

Bar Measures 1 inch

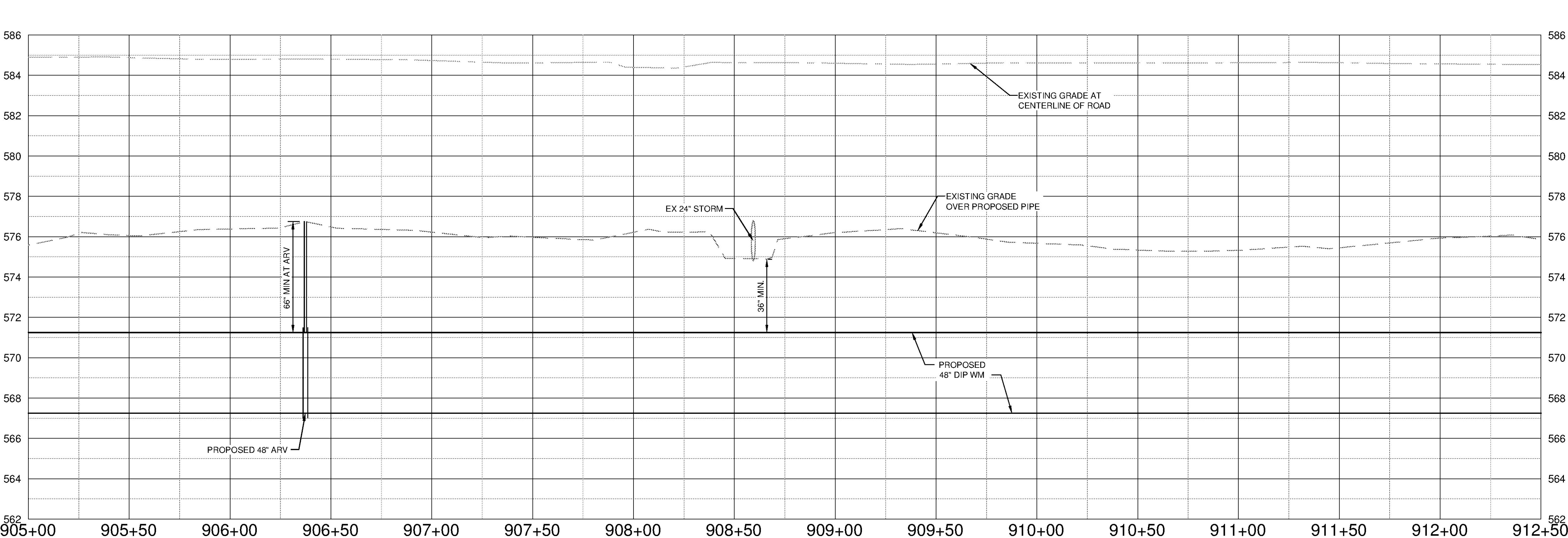

SCALE
HORIZ. 1" = 30'
VERT. 1" = 3'

10/9/2014 5:20:19 PM - P:\IER\11740\200-11740-10003\CAD\SHEETFILES\TREATMENT PLANT\FW\C-2027.DWG - DAVALOS, PAULA