

10/9/2014 5:00:07 PM - P:\IER\11740\200-11740-10003\CAD\SHEETFILES\TREATMENT PLANT\FWC-2017 TO C-2020.DWG - DAVALOS, PAULA

MATCHLINE STA: 845+00

MATCHLINE STA: 852+50

**NOTES:**

- 1. ALL DISTURBED AREAS SHALL BE RESODDED OR SEED IN ACCORDANCE WITH THE LATEST ALDOT SPECIFICATIONS FOR GRASSING OR AS DIRECTED BY THE DEPARTMENT OF TRANSPORTATION'S DISTRICT MANAGER.
- 2. ALL TRAFFIC CONTROL SHALL BE IN ACCORDANCE WITH THE MOST CURRENT EDITION OF PART 6 OF THE MANUAL ON UNIFORM TRAFFIC CONTROL DEVICES (MUTCD).
- 3. THE UTILITY AGREES TO ABIDE BY AND FOLLOW THE GUIDELINES SET FORTH IN THE ALABAMA HANDBOOK FOR EROSION CONTROL AND STORM WATER MANAGEMENT ON CONSTRUCTION SITES AND URBAN AREAS.
- 4. ALL MANHOLES, VALVE BOXES, AND HANDHOLES SHOULD BE MOUNTED FLUSH WITH EXISTING GROUND.

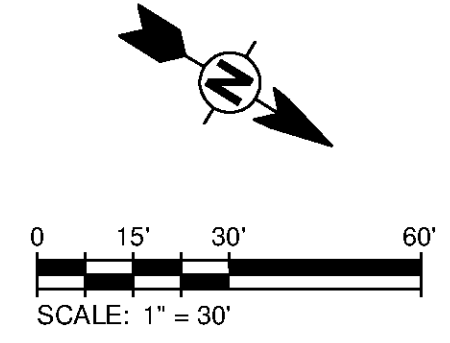

SPEED  
LIMIT  
65

**U.S. HIGHWAY 431 / SR-1**

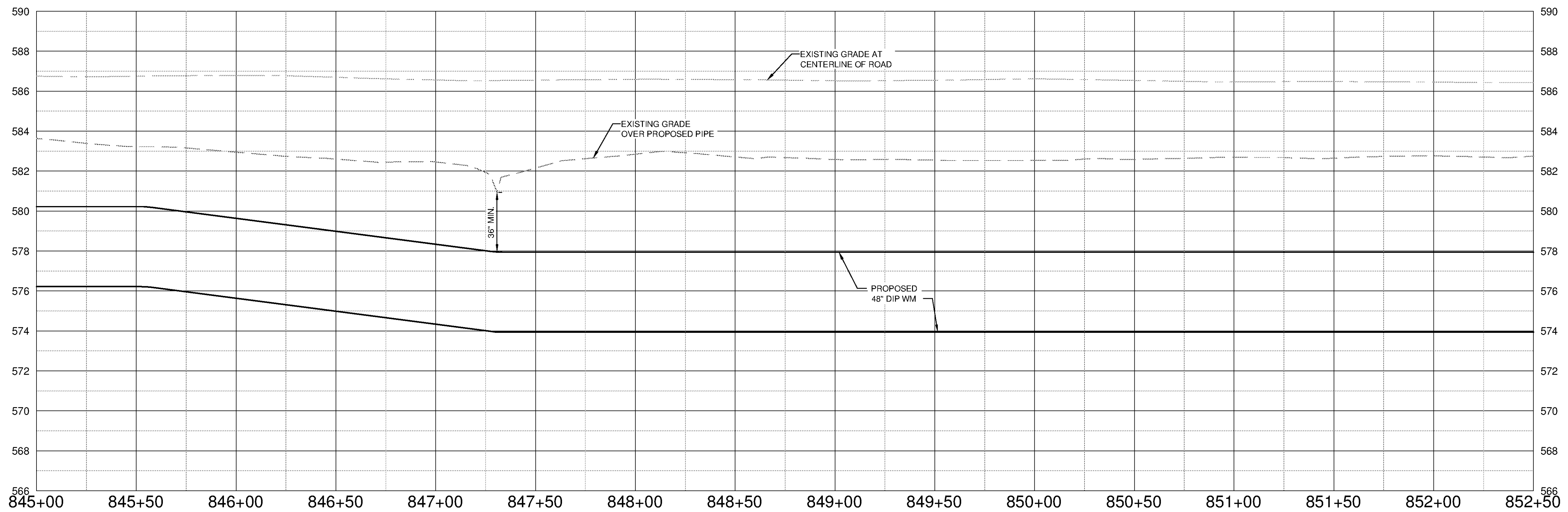
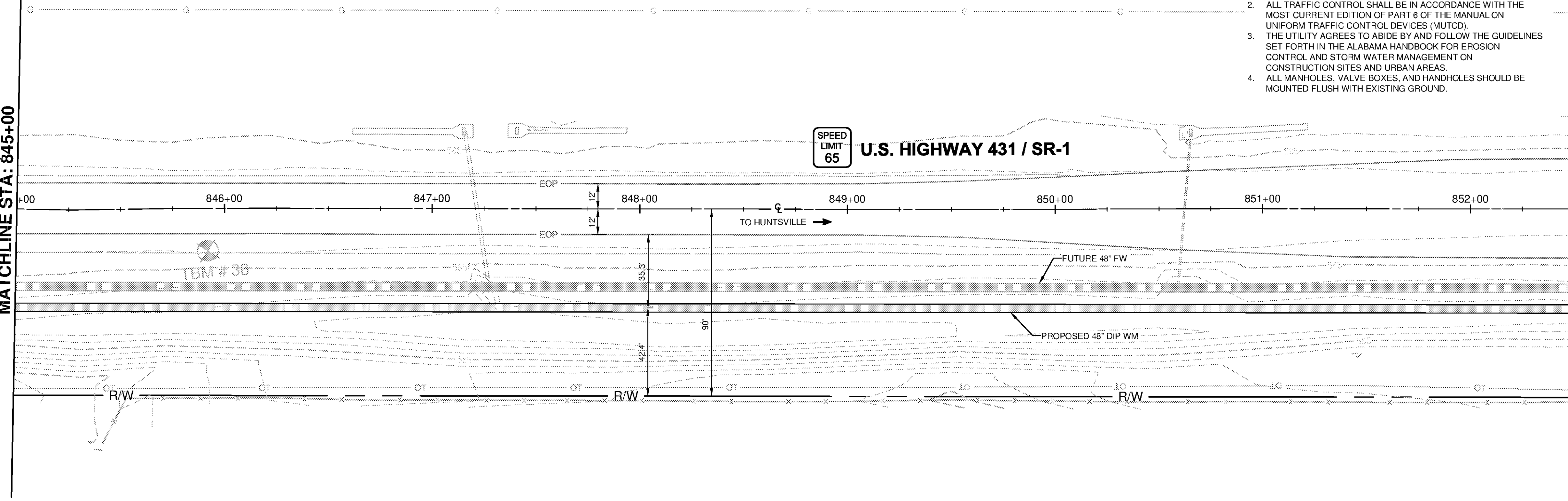

SCALE  
HORIZ. 1" = 30'  
VERT. 1" = 3'



BID SET

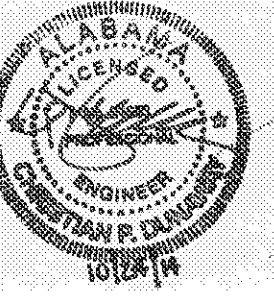

BY	DATE	DESCRIPTION

HUNTSVILLE UTILITIES  
SOUTHEAST WATER TREATMENT PLANT

**FINISHED WATER MAIN  
PLAN AND PROFILE**

STA 845+00 TO 852+50

Project No.: 200-11740-10003  
Designed By: DNL  
Drawn By: WDV  
Checked By: JPT

**C-2019**

Copyright Tetra Tech  
Bar Measures 1 inch