

### STORMWATER DRAINAGE TABLE

Basin	Structures			Overland Flow to Basin		R off Coef. C	Q (cfs)	From Str.	To Str.	Over-land	Flow Within System		Pipe Size (in.)	Length (ft)	Drop (ft.)	Slope	Allow. Q (cfs)	Remarks	Pass or Fail (1 - Pass, 0 - Fail)	
	Rim	Inv. In.	Inv. Out.	Area (sq)	(in/hr)						Total Q (cfs)	n								
CB15	617.00	599.41	611.00	0.90	11.40	0.51	5.2	CB15	FES14	5.2	3.0	8.2	0.012	18	146	3.20	2.19%	16.9	RCP - CLASS III	1.0
CB3	604.80	599.41	599.41	0.76	11.40	0.65	5.8	CB3	CB2	5.6	0.0	5.6	0.012	18	65	1.31	2.02%	16.2	RCP - CLASS III	1.0
CB2	604.70	598.10	598.00	2.10	11.4	0.51	12.2	CB2	FES16	12.2	13.8	26.0	0.012	24	215	5.00	2.33%	37.5	RCP - CLASS III	1.0
CB5	604.42	599.41	599.31	0.56	11.4	0.78	5.0	CB5	CB28	5.0	8.5	13.5	0.012	24	163	3.56	2.18%	36.3	RCP - CLASS III	1.0
CB28	604.00	595.75	595.65	0.31	11.4	0.75	2.7	CB28	MH6	2.7	16.7	19.4	0.012	30	31	0.35	1.13%	47.3	RCP - CLASS III	1.0
CB8	605.75	595.65	598.89	0.37	11.4	0.54	2.3	CB8	CB9	2.3	0.0	2.3	0.012	15	163	1.63	1.00%	7.0	RCP - CLASS III	1.0
CB4	603.92	600.00	600.00	1.43	11.4	0.52	8.5	CB4	CB5	8.5	0.0	8.5	0.012	24	29	0.59	2.03%	35.0	RCP - CLASS III	1.0
CB7	603.00	596.40	596.40	0.42	11.4	0.66	3.2	CB7	CB28	3.2	0.0	3.2	0.012	15	66	0.75	1.14%	7.5	RCP - CLASS III	1.0
CB18	620.75	614.00	614.00	0.12	11.4	0.95	1.3	CB18	CB20	1.3	1.0	2.3	0.012	15	132	1.32	1.00%	7.0	RCP - CLASS III	1.0
CB20	620.75	615.44	607.68	0.13	11.4	0.95	1.4	CB20	CB21	1.4	3.7	5.1	0.012	18	75	2.26	3.01%	19.8	RCP - CLASS III	1.0
CB9	604.50	597.26	597.26	0.07	11.4	0.50	0.4	CB9	FES11	0.4	2.5	2.9	0.012	15	183	3.67	2.01%	9.9	RCP - CLASS III	1.0
CB10	604.50	598.20	598.20	0.03	11.4	0.61	0.2	CB10	CB9	0.2	0.0	0.2	0.012	15	47	0.94	2.00%	9.9	RCP - CLASS III	1.0
MH6	605.00	595.30	595.20	0.00	0.0	0.00	0.0	MH6	FES17	0.0	19.4	19.4	0.012	30	284	4.90	1.73%	58.6	RCP - CLASS III	1.0
CB21	609.91	605.42	602.67	0.06	11.4	0.35	0.2	CB21	CB29	0.2	5.1	5.3	0.012	18	83	1.67	2.01%	16.2	RCP - CLASS III	1.0
CB29	605.50	601.00	597.00	0.50	11.4	0.46	2.6	CB29	MH30	2.6	5.3	7.9	0.012	24	113	0.85	0.75%	21.3	RCP - CLASS III	1.0
MH30	611.87	596.15	596.05	0.00	0.0	0.00	0.0	MH30	FES31	0.0	7.9	7.9	0.012	24	140	1.05	0.75%	21.3	RCP - CLASS III	1.0
FES14	607.80						8.2													
FES16	593.00																			
FES17	590.30																			
FES11	593.59																			
FES31	596.00																			
Piping around chem feed																				
							2.700													
							1.020													
							3.0													

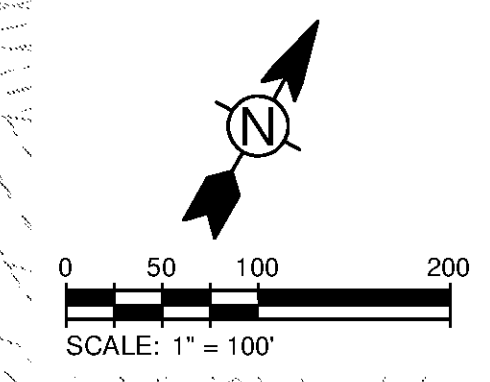
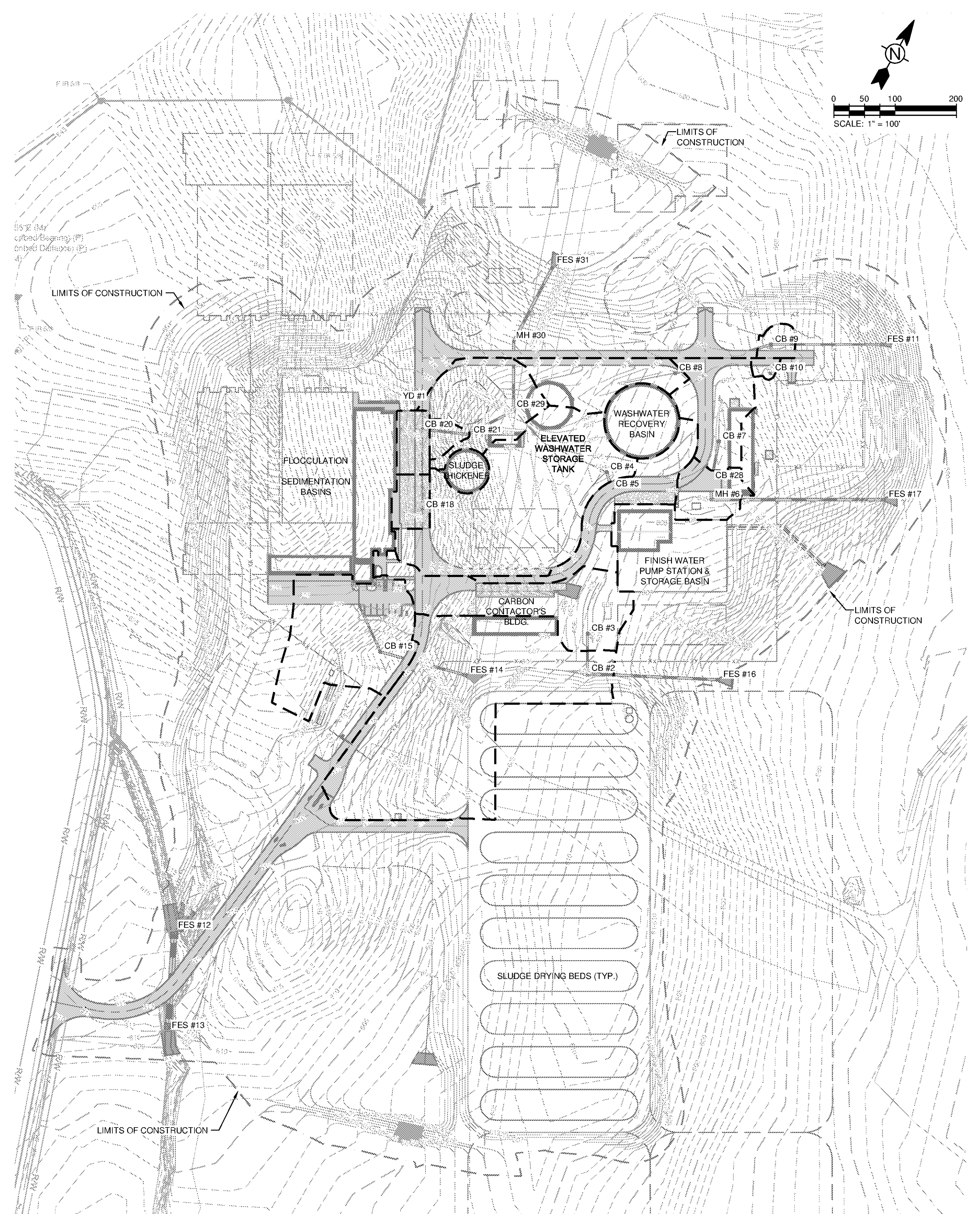

10/1/2014 3:07:16 PM - \\ERS161\FS1\PROJECTS\IER11740\200-11740-10003\CAD\SHEET\TREATMENT PLANT\WP-C-1112-BASIN SITE PLAN.DWG - REYES, HECTOR

**TETRA TECH**  
www.tetra.tech.com  
101 QUALITY CIRCLE, SUITE 140  
HUNTSVILLE, ALABAMA 35806  
PHONE: (256) 424-4077 FAX: (256) 424-4097

BID SET  
*[Signature]*  
10/24/14

BY	DATE	DESCRIPTION

HUNTSVILLE UTILITIES  
SOUTHEAST WATER TREATMENT PLANT  
**STORMWATER DRAINAGE TABLE, SITE BASIN PLAN**

Project No.: 200-11740-10003  
Designed By: JRW  
Drawn By: WDV  
Checked By: JPT

**C-1112**

Copyright: Tetra Tech  
Bar Measures 1 inch