

Replanting Calculations are for this tree removal and the tree removal included in the CMAR tree removal plan set.

Trees to be removed in the scope only. Trees outside of these limits are included in a different bid package

RECOMPENSE PLANT LIST							
QTY	BOTANICAL	COMMON	CAL.	RECOMPENSE	HT.	SPR.	ROOT
124	Quercus shumardii	Shumard Oak	3"	372"	12'-14"	5'-6"	B&B
30	Acer rubrum	Red Maple	3"	90"	12'-14"	5'-6"	B&B
48	Liriodendron tulipifera	Red Maple	3"	144"	12'-14"	5'-6"	B&B
282	Pinus taeda	Loblolly Pine	3"	846"	12'-14"	5'-6"	B&B
484	Total Trees Recompensed			1452"	Total Inches Recompensed		

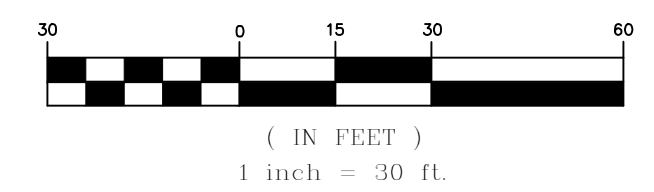

TREES REMOVED	
COMMON NAME	DIA.
1 Oak	42"
2 Oak	33"
3 Oak	29"
4 Oak	25"
5 Oak	25"
6 Oak	24"
41 Pine	24"
42 Oak	49"
43 Pine	36"
TOTAL INCHES REMOVED: 287"	
TOTAL TREES REMOVED: 9	

TREE RECOMPENSE CALCULATIONS	
TOTAL CALIPER INCHES REQUIRED FOR RECOMPENSE: (Total Inches Removed + Total Inches Lost)	287
TOTAL CALIPER INCHES PROVIDED: (Total Inches Recompensed)	-
TOTAL CALIPER INCHES SAVED: (Total Inches To Remain)	N/A
TOTAL TREES SAVED: (Total Trees To Remain)	N/A
TOTAL NUMBER OF IMPACTED TREES: (Total Trees Removed + Total Trees Lost)	9
TOTAL NUMBER OF TREES PROVIDED: (Total Trees Recompensed)	-

Trees recompense at 1" for 1" ratio, with minimum tree of 2.5" Caliper

96 Trees proposed for Recompense at 3" Caliper = 288" of Recompense  
287" Removed

TREE REMOVAL LEGEND	
# X	SPECIMEN TREE TO BE REMOVED
X	NON SPECIMEN TREE TO BE REMOVED

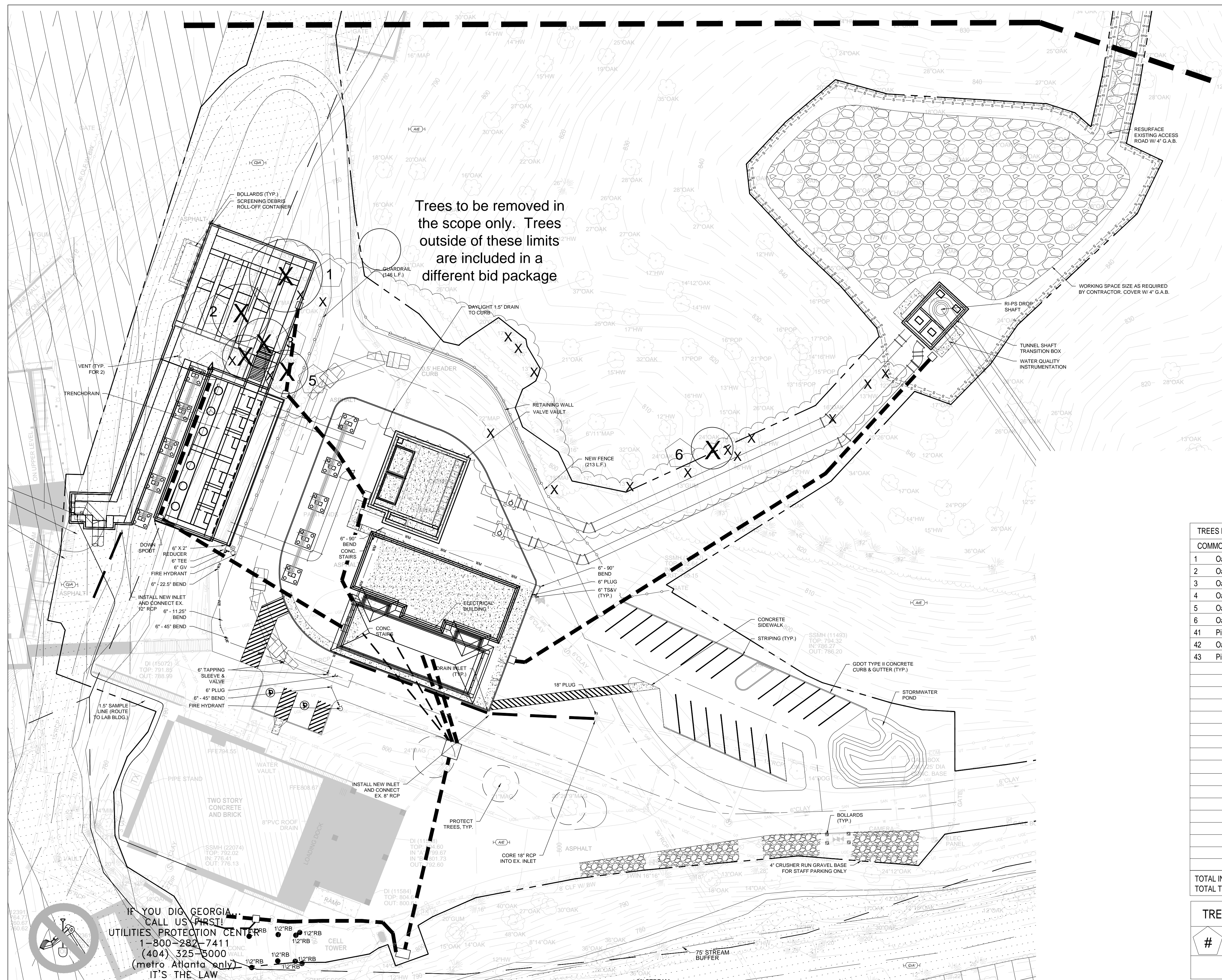

IF YOU DIG GEORGIA...  
CALL US FIRST!  
UTILITIES PROTECTION CENTER  
1-800-282-7411  
(404) 325-5000  
(metro Atlanta only)  
IT'S THE LAW



No.	Description	Date

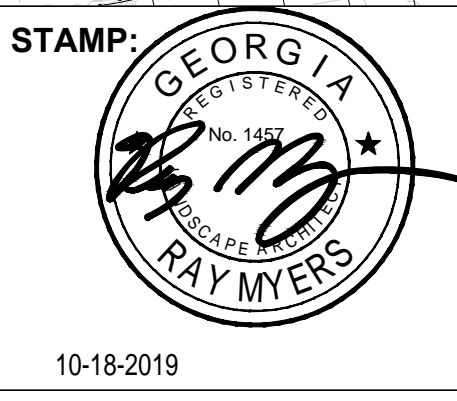

ADDRESS:  
BGR2-JV  
6 CONCOURSE PARKWAY  
SUITE 1600  
ATLANTA, GA 30328  
(770) 569-7038 x101  
FAX: (770) 993-5082

PROJECT NO:	RAA DESIGN
DESIGNED BY:	MAW
DRAWN BY:	REM
CHECKED BY:	REM
DATE:	06/07/2018
SCALE:	1"=30'-0"

CITY OF ATLANTA DEPT. OF WATERSHED MANAGEMENT  
**WATER SUPPLY PROGRAM**  
**RIVER INTAKE PUMP STATION**  
SITE 1  
**TREE RECOMPENSE PLAN**

DRAWING NO.  
**RI-PS**  
**TRP-1**  
SHEET OF











**RECOMPENSE PLANT LIST**

QTY	BOTANICAL	COMMON	CAL.	RECOMPENSE	HT.	SPR.	ROOT
124	Quercus shumardii	Shumard Oak	3"	372"	12'-14'	5'-6'	B&B
30	Acer rubrum	Red Maple	3"	90"	12'-14'	5'-6'	B&B
48	Liriodendron tulipifera	Red Maple	3"	144"	12'-14'	5'-6'	B&B
282	Pinus taeda	Loblolly Pine	3"	846"	12'-14'	5'-6'	B&B
484	Total Trees Recompensed			1452"	Total Inches Recompensed		

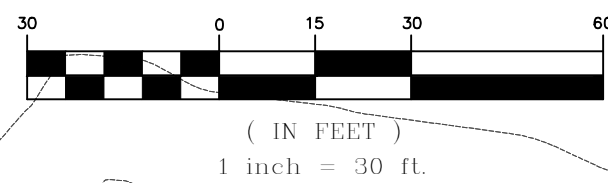

(31) Tulip Poplar  
 (107) Loblolly Pine  
 (15) Red Maple  
 (52) Shumard Oak

Previously proposed trees for Hemphill and Quarry Pump Station  
 Tree Recompense Requirements (Typ.)

(17) Tulip Poplar  
 (175) Loblolly Pine  
 (15) Red Maple  
 (72) Shumard Oak



IF YOU DIG GEORGIA...  
 CALL US FIRST!  
 UTILITIES PROTECTION CENTER  
 1-800-282-7411  
 (404) 325-5000  
 (metro Atlanta only)  
 IT'S THE LAW

CHAINLINK FENCE

QUARRY RIM



No.	Description	Date

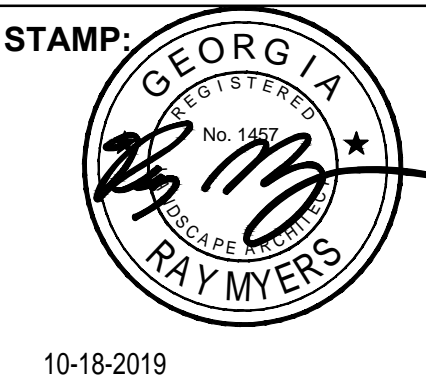

ADDRESS:  
 BGR2-JV  
 6 CONCOURSE PARKWAY  
 SUITE 1600  
 ATLANTA, GA 30328  
 (770) 569-7038 x101  
 FAX: (770) 993-5082

PROJECT NO:	RAA DESIGN
DESIGNED BY:	MAW
DRAWN BY:	REM
CHECKED BY:	REM
DATE:	06/07/2018
SCALE:	1"=40'-0"

CITY OF ATLANTA DEPT. OF WATERSHED MANAGEMENT  
**WATER SUPPLY PROGRAM**  
**RIVER INTAKE PUMP STATION**  
 SITE 1  
**TREE RECOMPENSE PLAN**

DRAWING NO.  
**RI-PS**  
**TRP-4**  
 SHEET OF



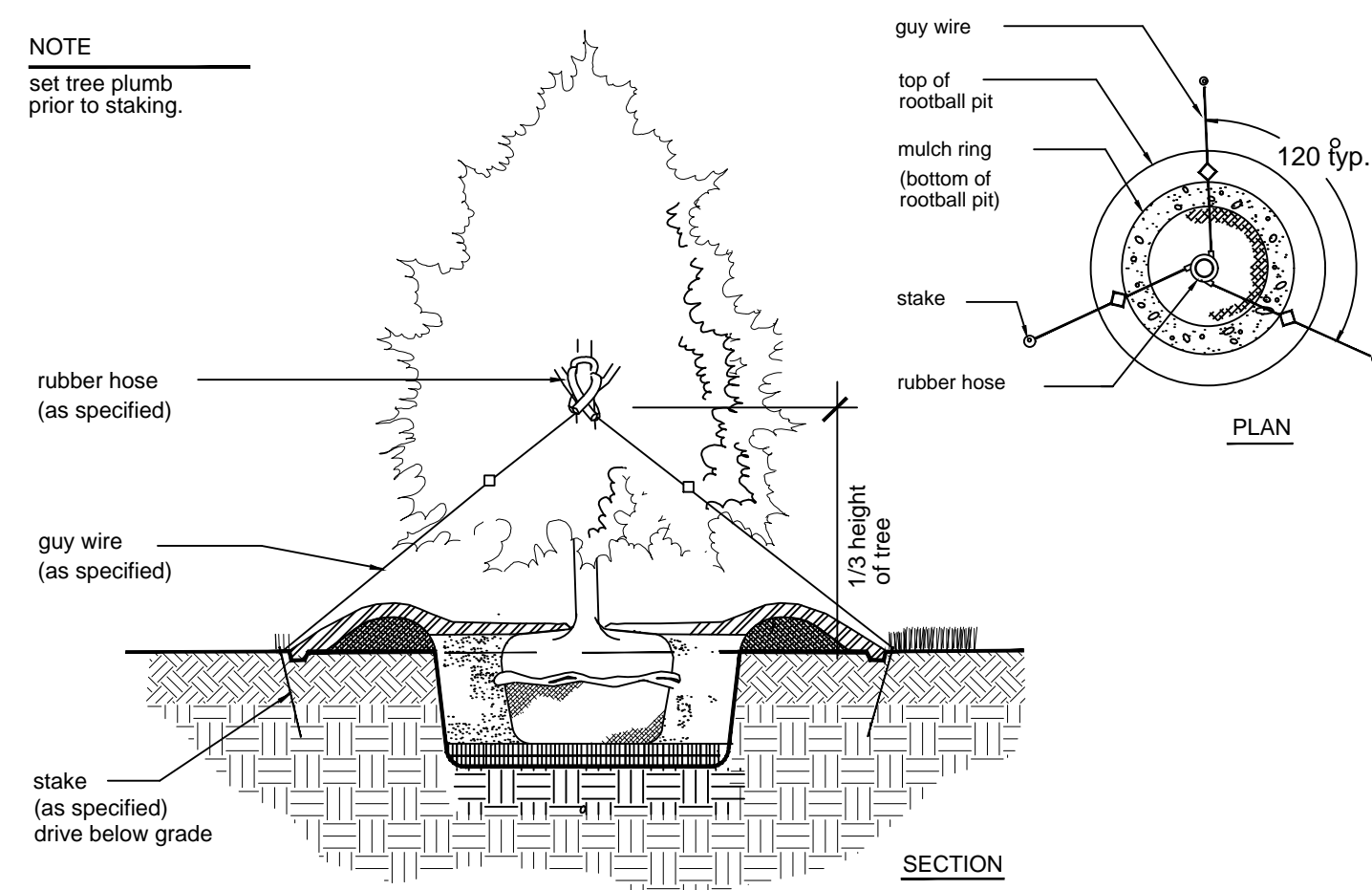

**EVERGREEN TREE STAKING**  
N.T.S.

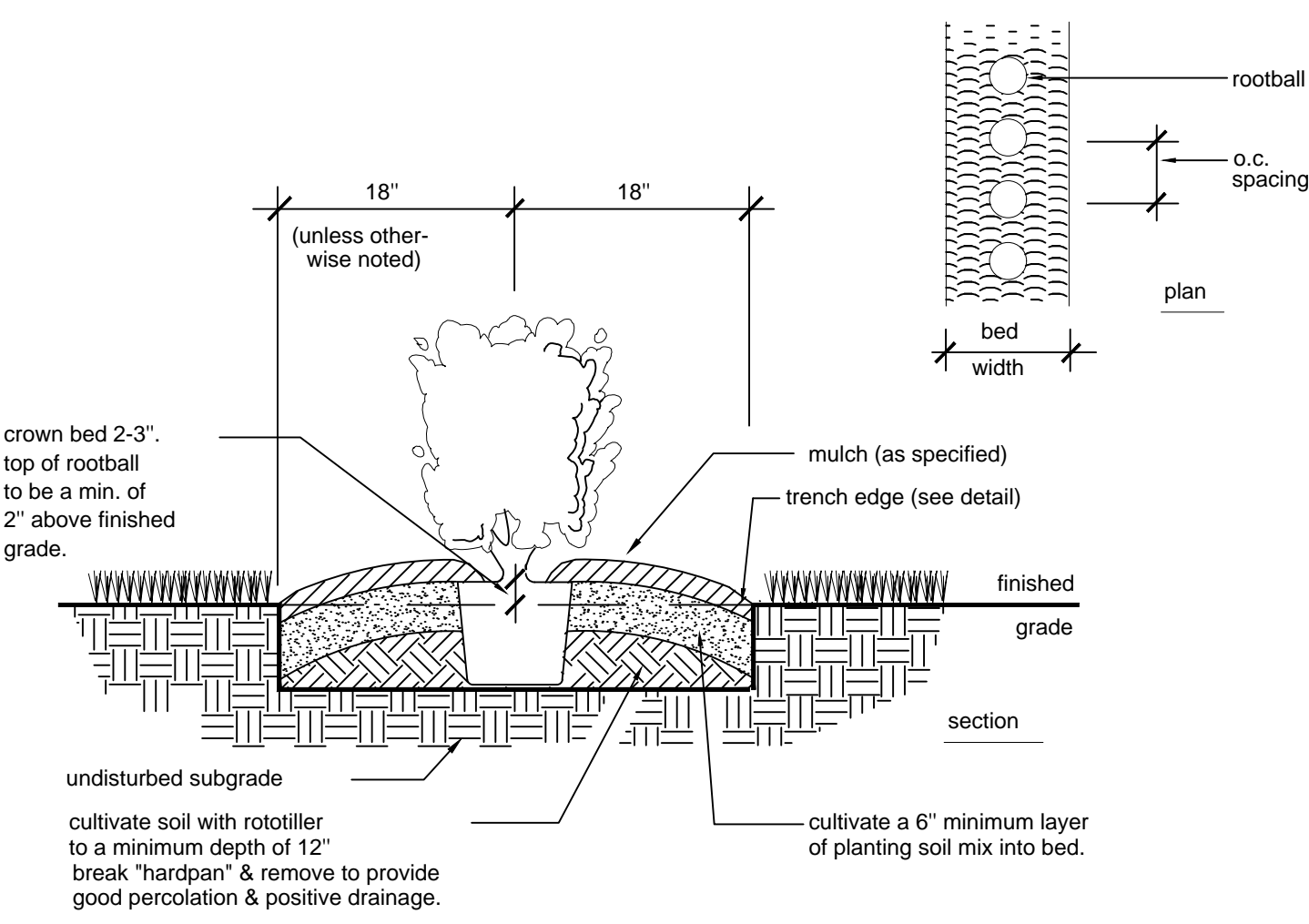

**HEDGE PLANTING (SINGLE ROW)**  
N.T.S.

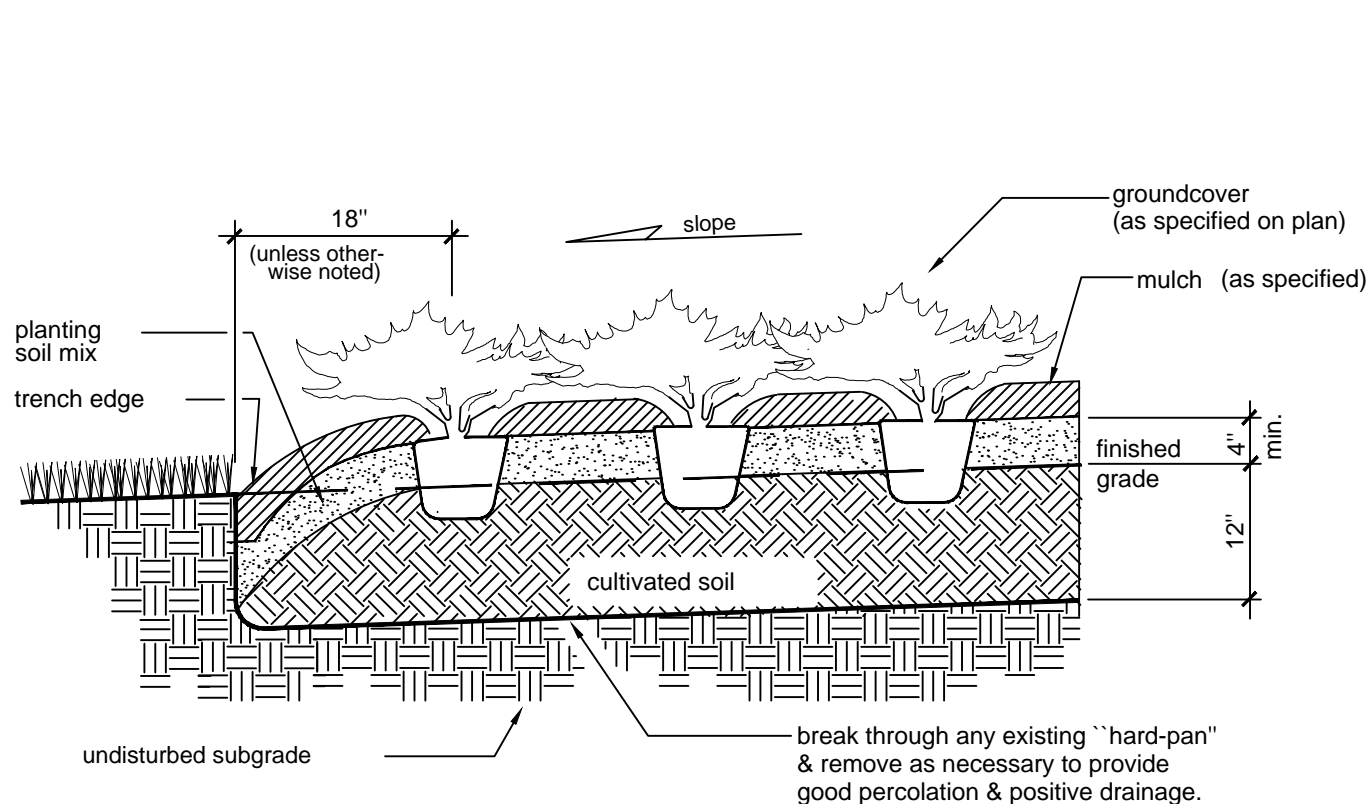

**GROUNDCOVER PLANTING**  
N.T.S.

**GENERAL PLANTING NOTES:**

1. all plants must be healthy, vigorous material; free of pests & diseases.
2. all plants must be container-grown or balled & burlapped (b&b) as indicated in the plant list.
3. all trees must be straight trunked, full headed & meet all requirements specified.
4. all plants are subject to the approval of the landscape architect & the owner before, during & after installation.
5. all trees must be guyed or staked as shown in the details.
6. all plants & planting areas must be completely mulched as specified.
7. prior to construction, the landscape contractor shall be responsible locating all underground utilities & shall avoid damage to all utilities during the course of the work. the landscape contractor is responsible for repairing any & all damage to utilities, structures, site appurtenances, etc. which occurs as a result of the landscape construction.
8. the landscape contractor is responsible for verifying all quantities shown on these plans before pricing the work.
9. the landscape contractor is responsible for fully maintaining all planting (including, but not limited to: watering, spraying, mulching, fertilizing, etc.) of planting areas & lawns until the work is accepted in total by the landscape architect & the owner.
10. the landscape contractor shall completely guarantee all plant material for a period of one (1) year beginning at the date of final acceptance. the landscape contractor shall promptly make all replacements before or at the end of the guarantee period (as per direction of the owner).
11. the owner agrees to perform all landscape maintenance (including watering) throughout the one year guarantee period unless otherwise determined.
12. the landscape architect will approve the staked location of all plant material prior to installation.
13. after being dug at the nursery source, all trees in leaf shall be acclimated for two (2) weeks under a mist system prior to installation.
14. any plant material which dies, turns brown or defoliates (prior to total acceptance of the work) shall be promptly removed from the site & replaced with material of the same species, quantity, size and meeting all plant list specifications.
15. standards set forth in 'american standards for nursery stock' represent guideline specifications only and constitute minimum quality requirements for plant material.

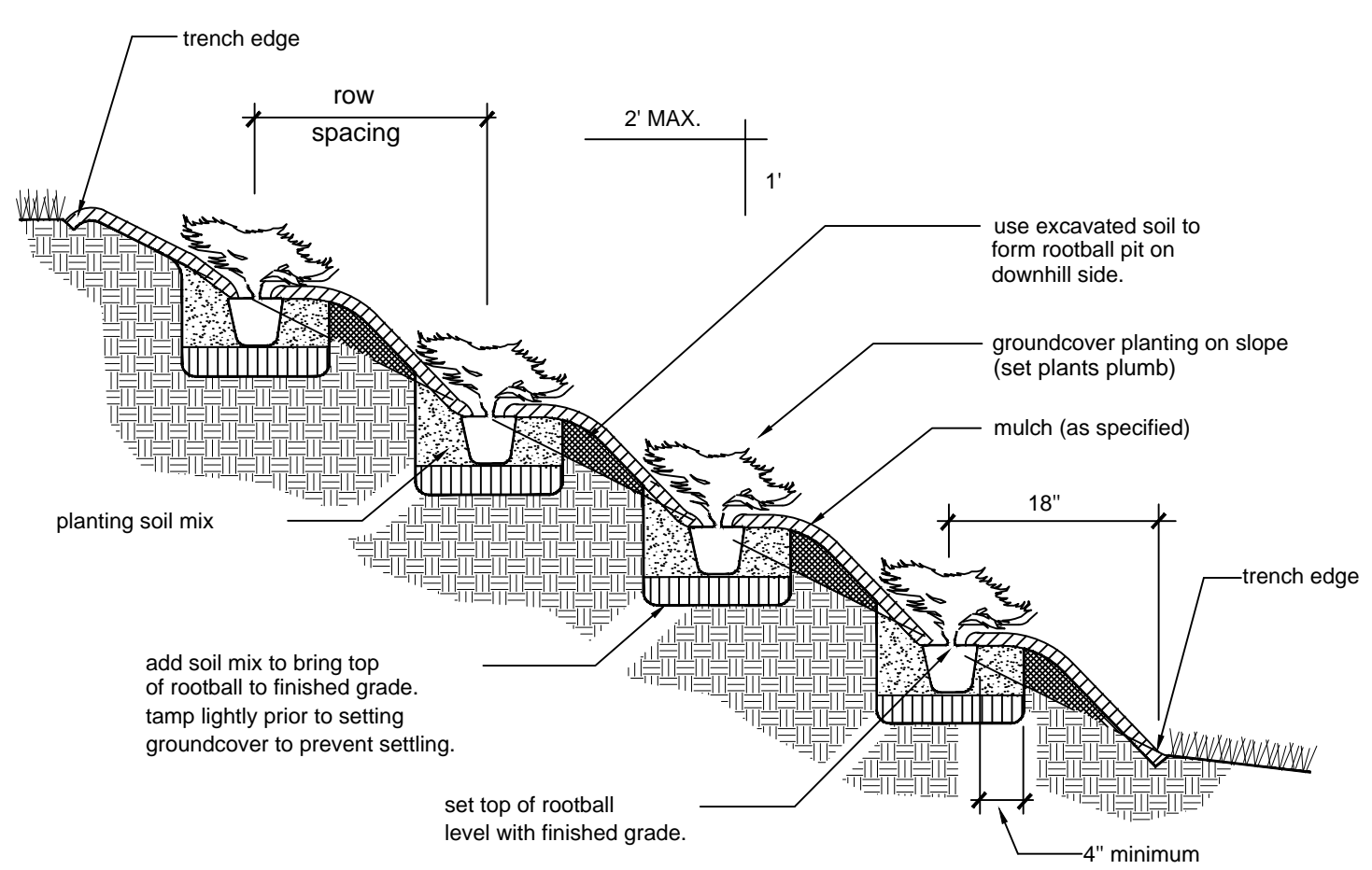

**GROUNDCOVER PLANTING ON SLOPE**  
N.T.S.

IF YOU DIG GEORGIA...  
CALL US FIRST!  
UTILITIES PROTECTION CENTER  
1-800-282-7411  
(404) 325-5000  
(metro Atlanta only)  
IT'S THE LAW



No.	Description	Date

STAMP:

ADDRESS:  
BGR2-JV  
6 CONCOURSE PARKWAY  
SUITE 1600  
ATLANTA, GA 30328  
(770) 569-7038 x101  
FAX: (770) 993-5082

PROJECT NO:	RAA DESIGN
DESIGNED BY:	MAW
DRAWN BY:	REM
CHECKED BY:	REM
DATE:	06/07/2018
SCALE:	1"=30'-0"

CITY OF ATLANTA DEPT. OF WATERSHED MANAGEMENT  
**WATER SUPPLY PROGRAM**  
**RIVER INTAKE PUMP STATION**  
SITE 1  
**TREE REPLACEMENT DETAILS**

DRAWING NO.  
**RI-PS**  
TRP-5  
SHEET OF