

DATE	REVISION	APP'D

CRABTREE CREEK INTERCEPTOR
STA. - 0+17.81 - 11+00

Moore, Gardner & Associates, Inc. Consulting Engineers
 MEMPHIS BEACH SOUTH CAROLINA
 RICHMOND VIRGINIA
 ASHEBORO, GREENSBORO, CARY NORTH CAROLINA
 BATON ROUGE LOUISIANA

WASTE WATER IMPROVEMENTS
WAKE COUNTY
 WAKE COUNTY, NORTH CAROLINA

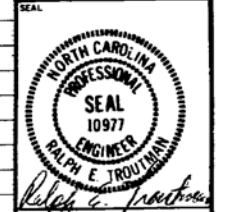

DATE	3-28-84
OFFICE	Asheboro
DRAWN BY	R.L.
CHECKED BY	
APPROVED BY	
SCALE	Noted
JOB NO.	02433
SHEET NO.	1 OF 21

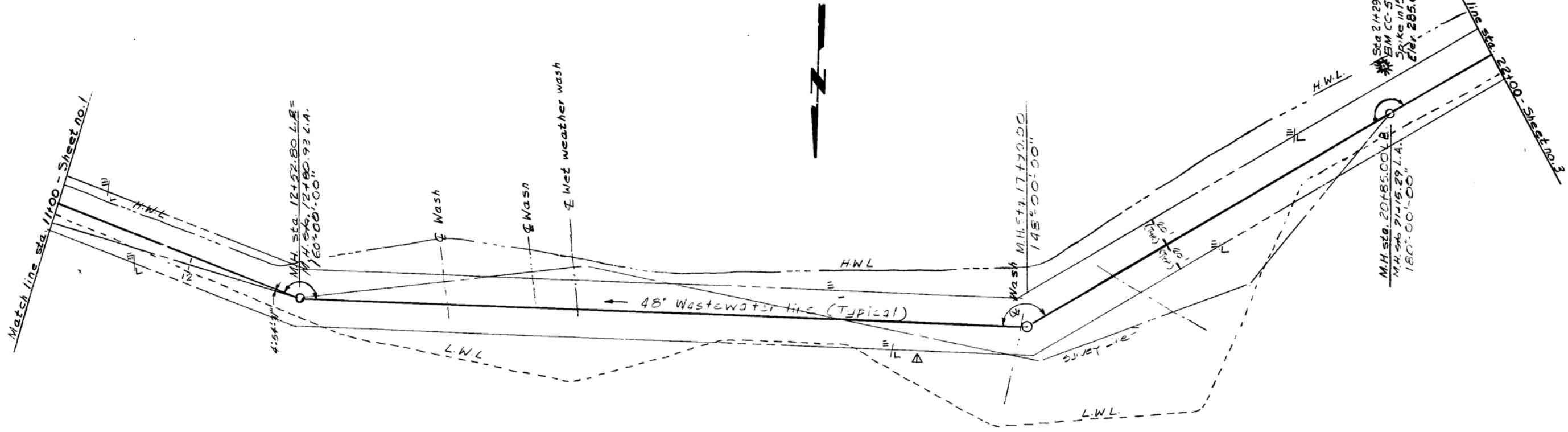

PLAN & PROFILE 1" = 40' Horiz.
1" = 4' Vert.

Plan FB #1, Pg. 8-11
Profile FB #1, Pg. 27-31

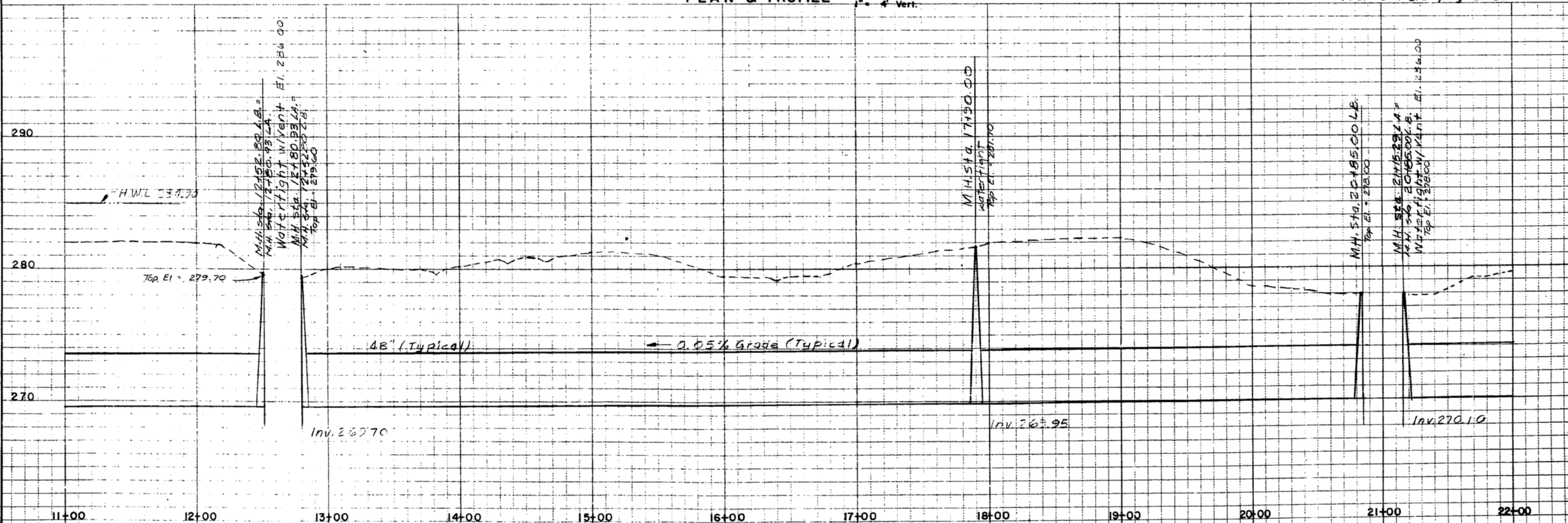

WASTE WATER IMPROVEMENTS WAKE COUNTY WAKE COUNTY, NORTH CAROLINA		Moore, Gardner & Associates ASHEBORO, GREENSBORO, CARY NORTH CAROLINA	
CRABTREE CREEK INTERCEPTOR STA. 11+00 - 22+00		Moore, Gardner & Associates, Inc. Consulting Engineers SURFSIDE BEACH SOUTH CAROLINA MEMPHIS TENNESSEE BATON ROUGE LOUISIANA	
SEAL NORTH CAROLINA PROFESSIONAL SEAL 10977 ENGINEER RALPH E. TRUETT R.E. Truett DATE 3-28-84 OFFICE Asheboro	DRAWN BY R.L. CHECKED BY APPROVED BY SCALE NOTED JOB NO. 02433 SHEET NO. 2 OF 21 SHEETS	DATE 3/83 DATE DATE	REVISION DATE MARK

Match line sta. 22+00 - Sheet no. 2

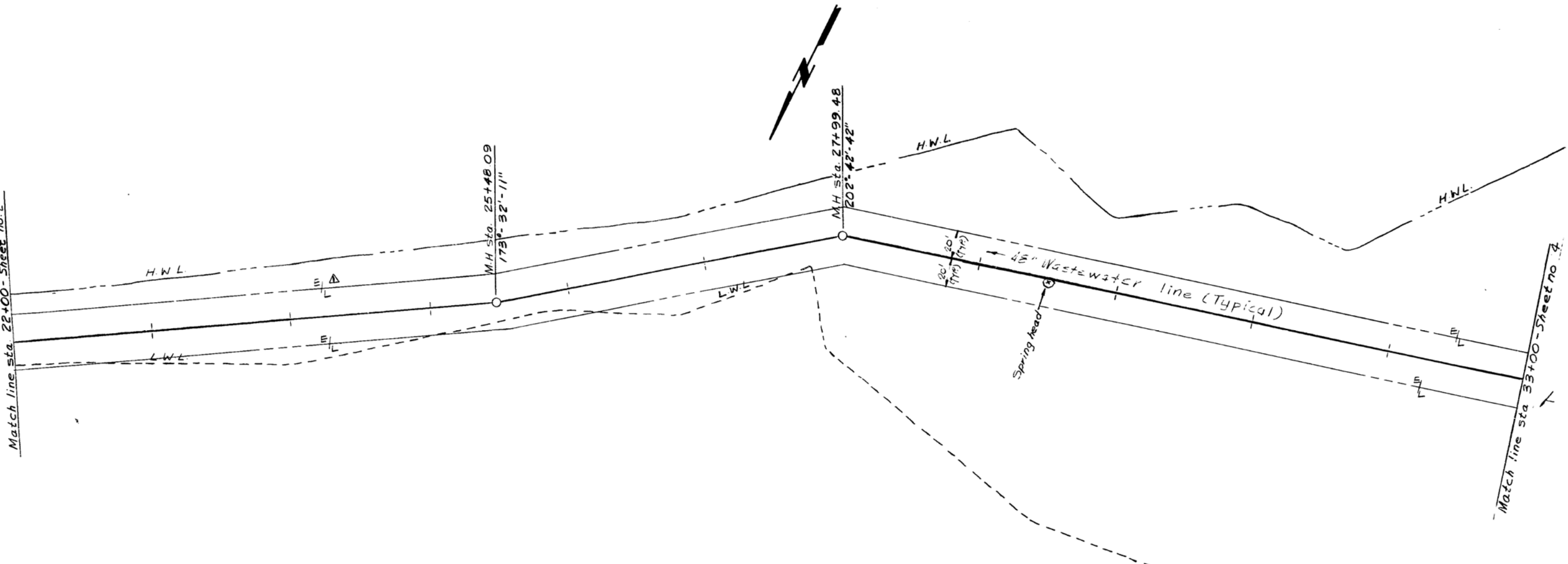

PLAN & PROFILE 1" = 40' Horiz. 1" = 4' Vert.

Plan FB #1, Pg. 11-14
Profile FB #1, Pg. 31-33

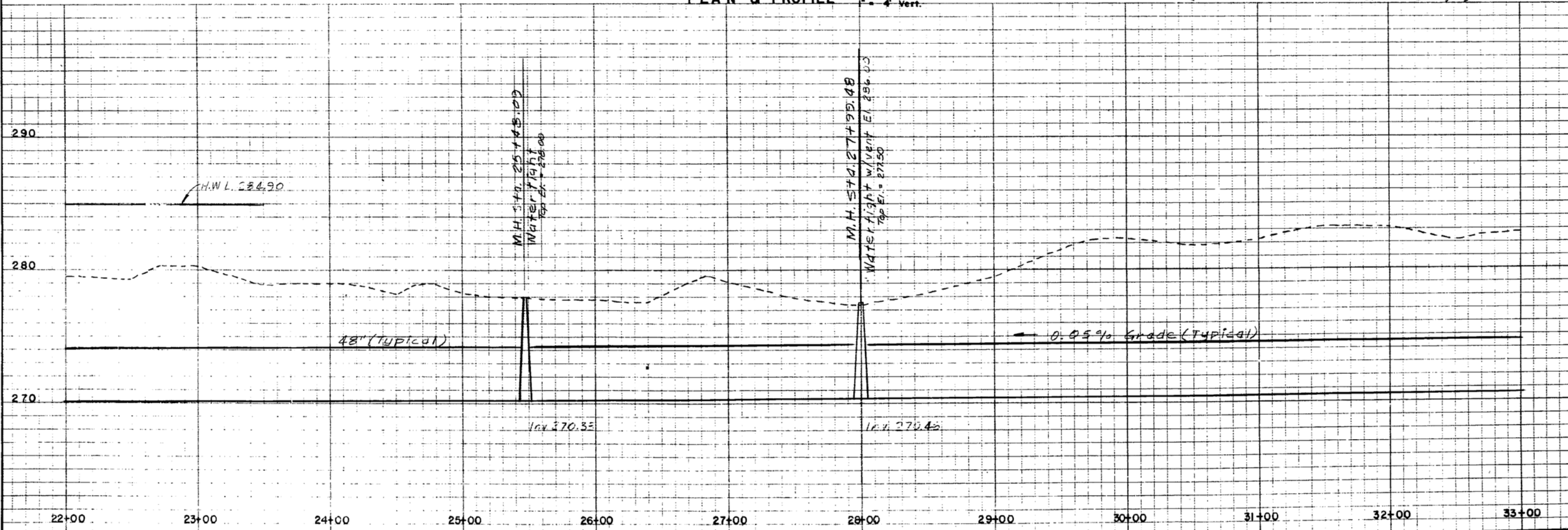

DATE	REVISION	APP'D

CRABTREE CREEK INTERCEPTOR
STA. 22+00 - 33+00

WAKE COUNTY
 WAKE COUNTY, NORTH CAROLINA

Moore, Gardner & Associates, Inc. • Consulting Engineers
 RICHMOND VIRGINIA
 SURFIDE BEACH SOUTH CAROLINA
 MEMPHIS TENNESSEE
 BATON ROUGE LOUISIANA



DATE	3-28-84
OFFICE	Asheboro
DRAWN BY	R.L.
CHECKED BY	
APPROVED BY	
SCALE	NOTED
JOB NO.	02433
SHEET NO.	3 OF 21

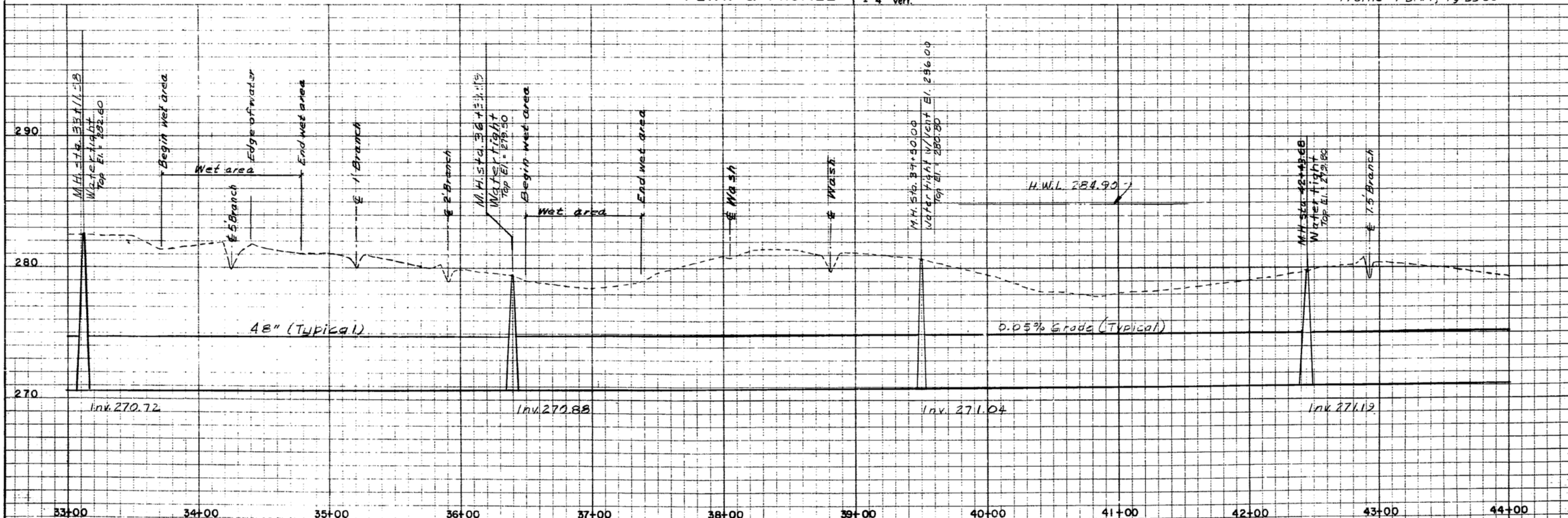
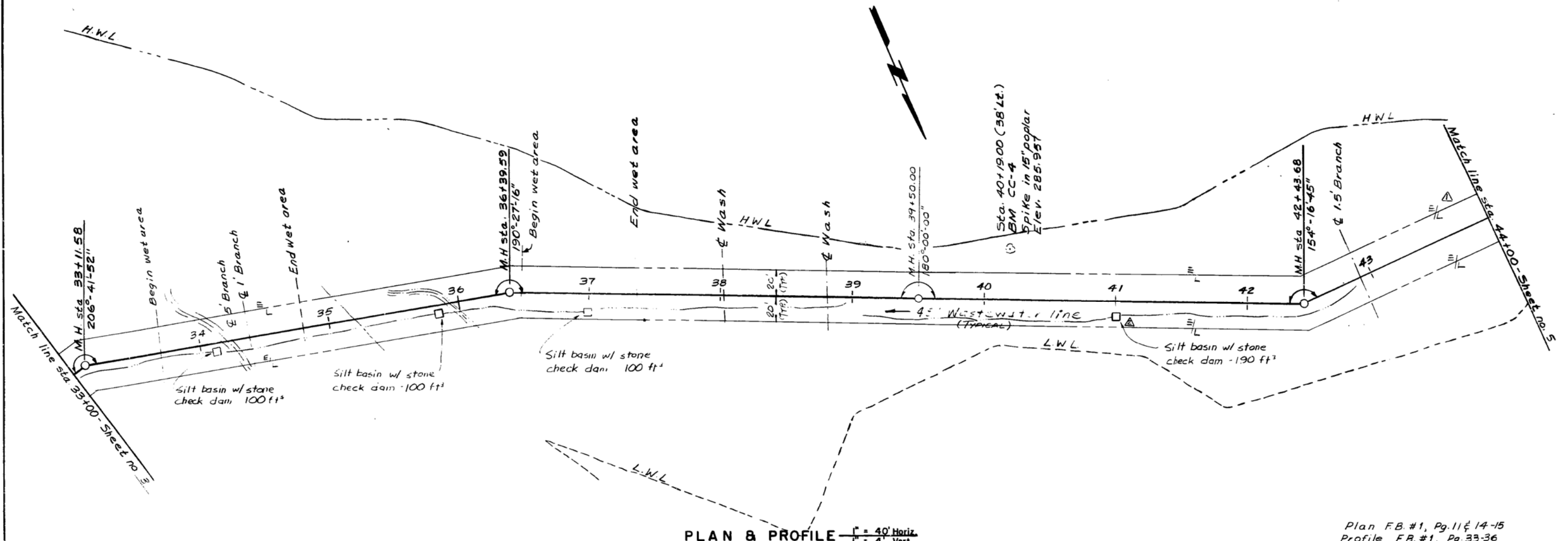

WASTE WATER IMPROVEMENTS WAKE COUNTY WAKE COUNTY, NORTH CAROLINA	CRABTREE CREEK INTERCEPTOR STA. 33+00 - 44+00
Moore, Gardner & Associates, Inc. ASHEBORO, GREENSBORO, CARY NORTH CAROLINA RICHMOND VIRGINIA MEMPHIS TENNESSEE SURFSIDE BEACH SOUTH CAROLINA BATON ROUGE LOUISIANA BIRMINGHAM ALABAMA	Consulting Engineers
SEAL NORTH CAROLINA PROFESSIONAL SEAL 10977 ENGINEER PAUL E. TROUTMAN Paul E. Troutman	DATE 3-28-84 OFFICE Asheboro DRAWN BY R.L. CHECKED BY APPROVED BY SCALE NOTED JOB NO. 02433 SHEET NO. 4 OF 21

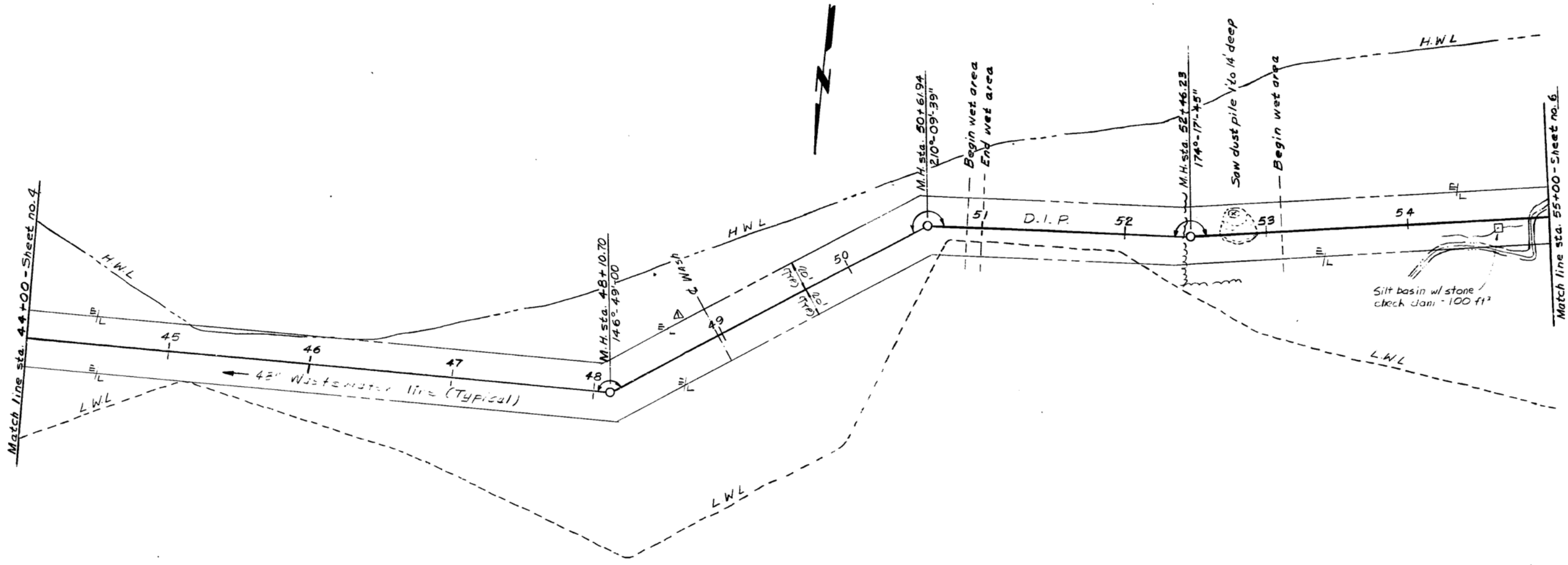

PLAN & PROFILE $\frac{1"}{40'}$ Horiz. $\frac{1"}{4'}$ Vert.

Plan F.B.#1, Pg 11 & 15-17
Profile F.B.#1, Pg 36-39

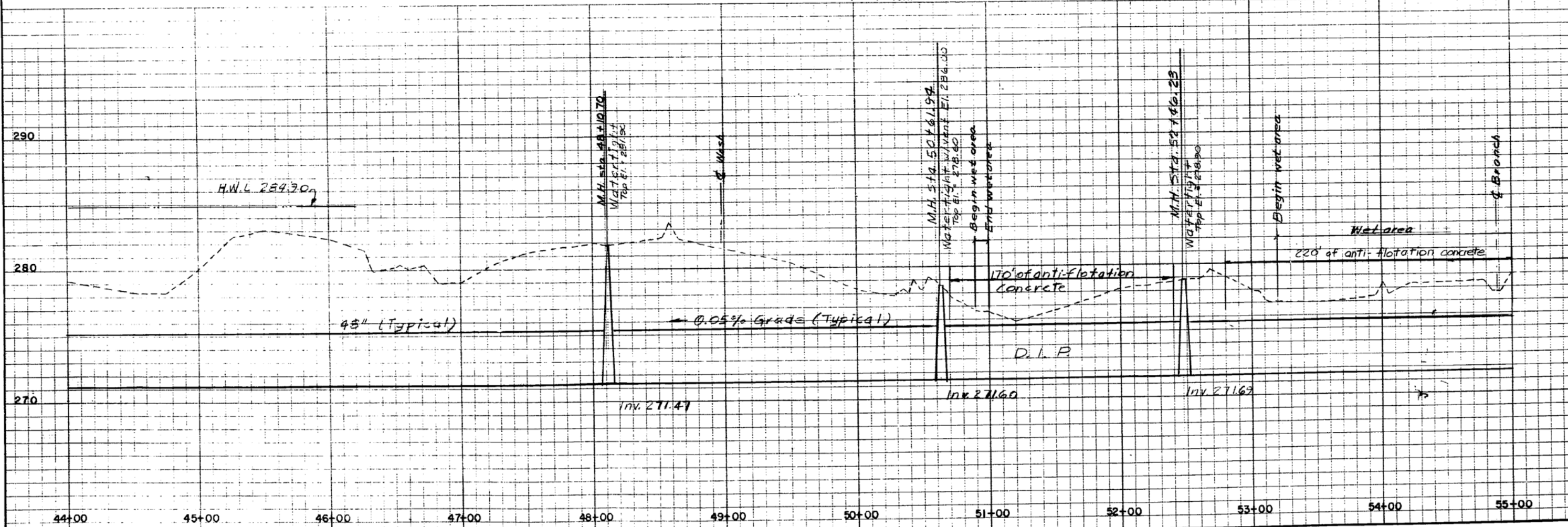

CRABTREE CREEK INTERCEPTOR STA. 44+00 - 55+00	
Moore, Gardner & Associates, Inc. Consulting Engineers MEMPHIS, TENNESSEE SURFIDE BEACH, SOUTH CAROLINA BATON ROUGE, LOUISIANA	
WASTE WATER IMPROVEMENTS WAKE COUNTY WAKE COUNTY, NORTH CAROLINA	
SEAL NORTH CAROLINA PROFESSIONAL ENGINEER SEAL 10917 R.L. FROST DATE 3-26-84 OFFICE Asheboro	
DRAWN BY R.L.	DATE 3/83
CHECKED BY	DATE
APPROVED BY	DATE
SCALE NOTED	
JOB NO. 02433	
SHEET NO. 5 OF 21	

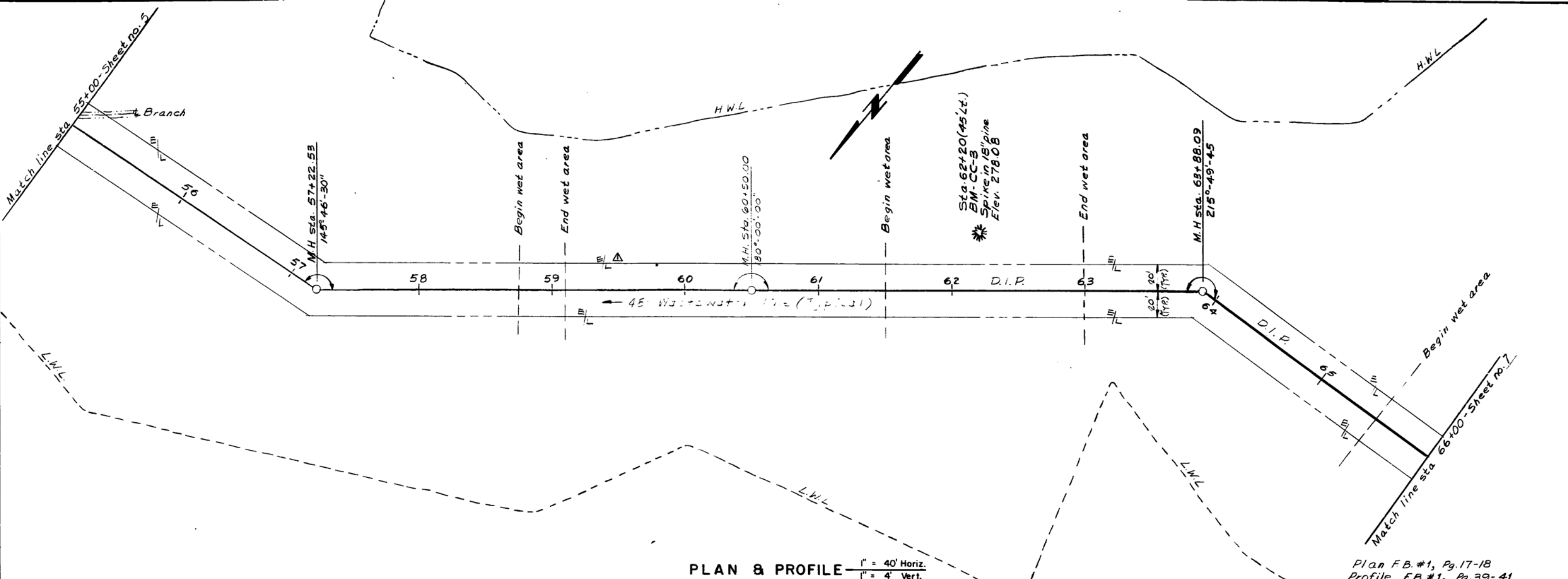

PLAN & PROFILE
 1" = 40' Horiz.
 1" = 4' Vert.

Plan FB #1, Pg. 17-18
 Profile FB #1, Pg. 39-41

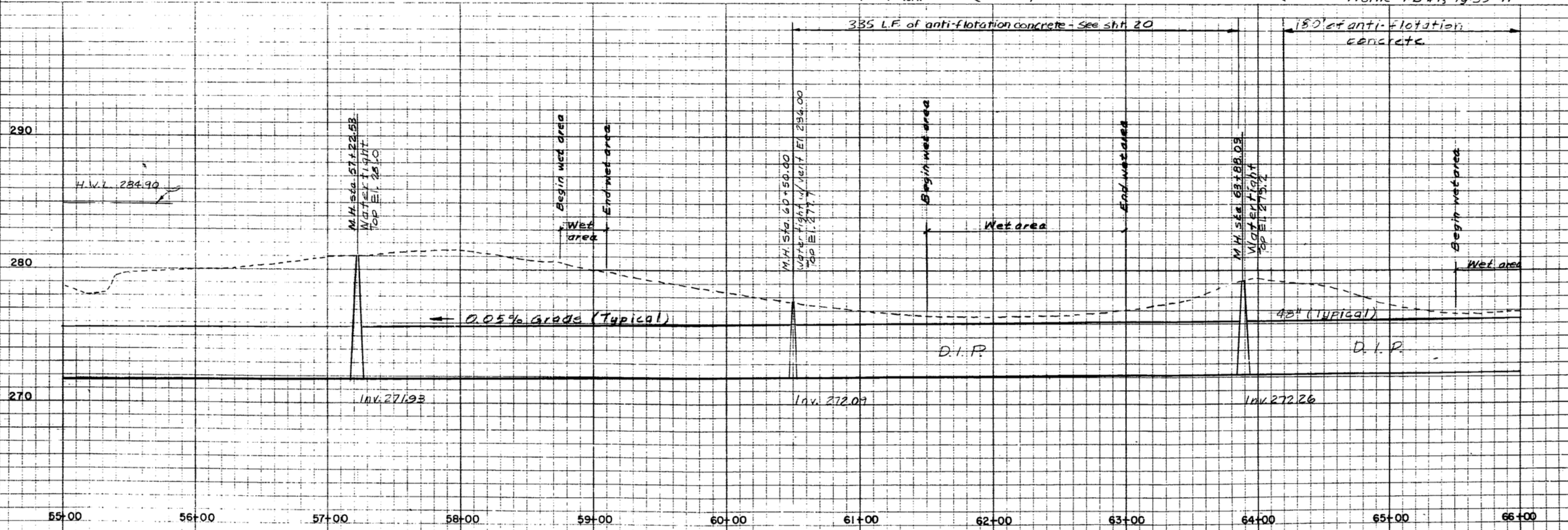

DATE	REVISIONS

CRABTREE CREEK INTERCEPTOR
 STA. 55+00 TO 66+00

Moore, Gardner & Associates, Inc. Consulting Engineers
 BAYON ROUGE, LOUISIANA
 MEMPHIS, TENNESSEE
 SOUTH CAROLINA
 VIRGINIA
 RICHMOND, VIRGINIA
 ASHEBORO, GREENSBORO, CARY, NORTH CAROLINA
 SURESIDE BEACH, SOUTH CAROLINA

WASTE WATER IMPROVEMENTS
WAKE COUNTY
 WAKE COUNTY, NORTH CAROLINA

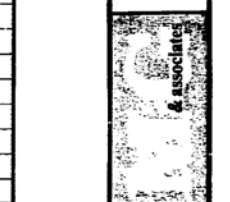

SEAL: NORTH CAROLINA PROFESSIONAL ENGINEER SEAL 10377 RALPH G. GARDNER

DATE: 3-28-84
 OFFICE: Asheboro

DRAWN BY: R.L. DATE: 3/85
 CHECKED BY: DATE:
 APPROVED BY: DATE:
 SCALE: NOTED
 JOB NO. 02433
 SHEET NO. 6 OF 21 SHEETS

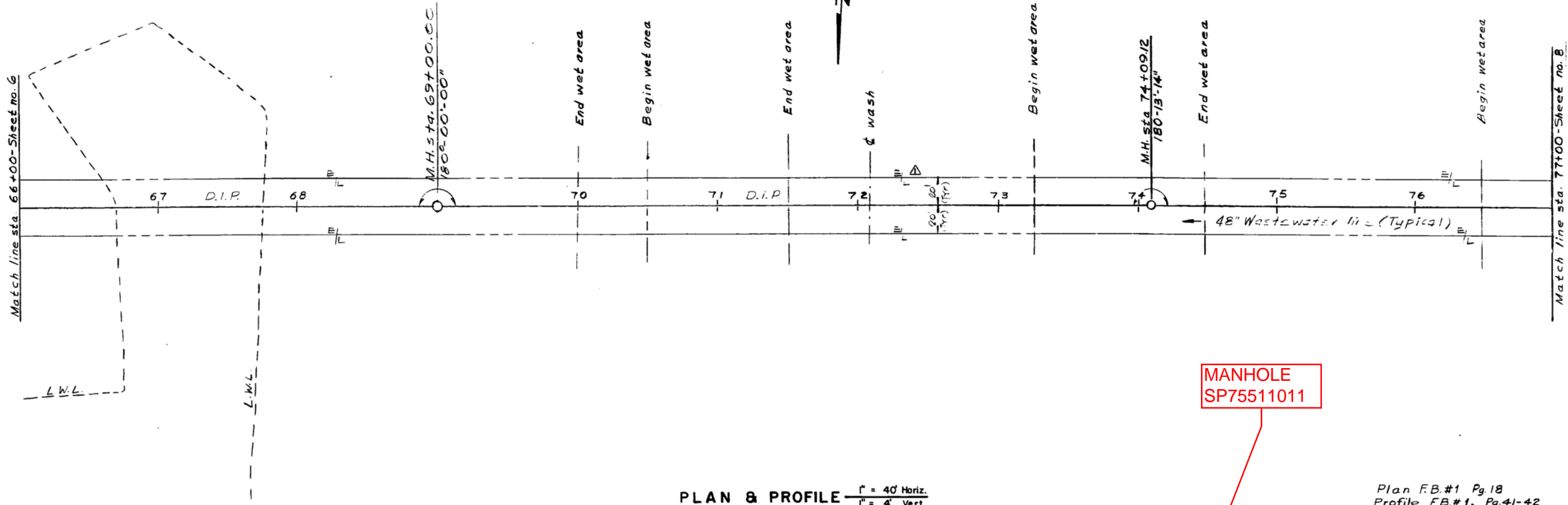

PLAN & PROFILE
 1" = 40' Horiz.
 1" = 4' Vert.

Plan F.B.#1 Pg.18
 Profile FB#1, Pg.41-42

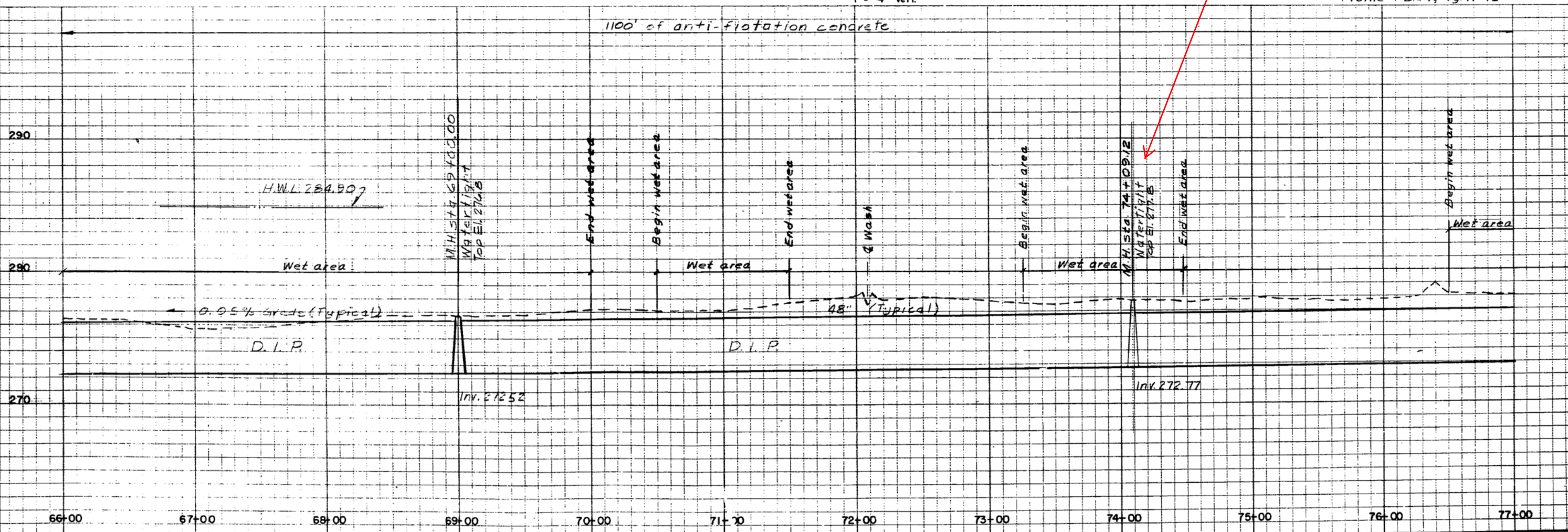

66+00 67+00 68+00 69+00 70+00 71+00 72+00 73+00 74+00 75+00 76+00 77+00

DATE	REVISION	APP.

WASTE WATER IMPROVEMENTS
WAKE COUNTY
 WAKE COUNTY, NORTH CAROLINA

Moore, Gardner & Associates, Inc. • Consulting Engineers
 ASHEBORO, GREENSBORO, CARY
 RICHMOND VIRGINIA
 SURFSIDE BEACH SOUTH CAROLINA
 MEMPHIS TENNESSEE
 BATON ROUGE LOUISIANA

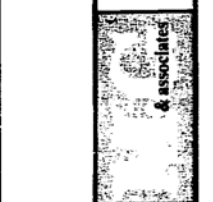

SEAL
 NORTH CAROLINA
 PROFESSIONAL
 SEAL
 10977
 ENGINEER
 RALPH E. TROUGHTON

Ralph E. Troughton
 DATE 3-28-84
 OFFICE Asheboro

DRAWN BY R.L. DATE 3/83
 CHECKED BY DATE
 APPROVED BY DATE

SCALE NOTED
 JOB NO. 02433
 SHEET NO. 7 OF 21 SHEETS

Match line sta. 77+00 - Sheet No. 1

M.H. sta. 78+86.14
180°-00'-00"

78

79

80

81

M.H. sta. 81+65.67
102°-39'-31" (B.I.D. M.H. by Sect. I)

SECTION I
SECTION II

Survey line
93°-03'-00"

Brier Creek Interceptor
(42") By others

Manhole by SECTION I.
Contractor to provide opngs
& construct inverts for
other tie-ins

End wet area

Begin wet area

6' Branch

6' Branch & End wet area

± 700' to 204.9 contour
High pool level

B.M. CC-2: Elev. 29.711
Spike in 36" sycamore 35'
left of survey line sta. 84+63

Silt basin w/
stone check dam
100 sq ft

Sta. 83+63.16

Branch

154°-51'-31"

Survey line

Basin wet area
(standing water)

36" Wastewater line

M.H. sta. 87+83.83 L.B.F.
M.H. sta. 87+96.88 L.A.
172°-40'-20"

Match line sta. 88+00 - Sheet 2

PLAN & PROFILE 1" = 40' Horiz.
1" = 4' Vert.

Plan: F.B. #1, Pg. 21, 47
Profile: F.B. #1, Pg. 42-43, 61

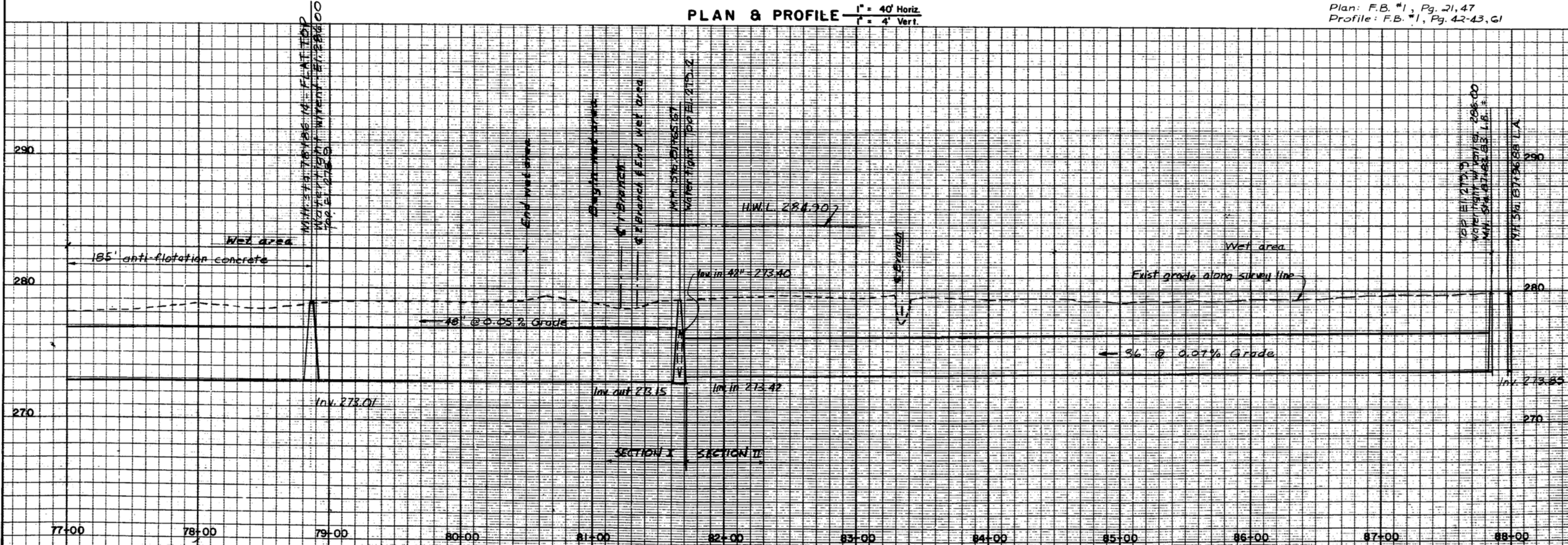

WASTEWATER IMPROVEMENTS
WAKE COUNTY
WAKE COUNTY, NORTH CAROLINA

CRABTREE CREEK INTERCEPTOR
STA. 77+00 - 88+00

DATE	3-25-84
SCALE	NOTED
APPROVED BY	[Signature]
CHECKED BY	[Signature]
DRAWN BY	[Signature]
DATE	3/83
DATE	12/84
DATE	12/84
REVISION	
MARK	
DATE	
REVISION	
DATE	
REVISION	
DATE	
REVISION	



DATE	3-25-84
OFFICE	Asheboro
DRAWN BY	R.L. S.P.
DATE	3/83
CHECKED BY	[Signature]
DATE	12/84
APPROVED BY	[Signature]
DATE	12/84
SCALE	NOTED
JOB NO.	02433
SHEET NO.	8 OF 21

Moore, Gardner & Associates, Inc. • Consulting Engineers
ASHEBORO, GREENSBORO, CARY
NORTH CAROLINA
RICHMOND BEACH
SOUTH CAROLINA
MEMPHIS
TENNESSEE
BATON ROUGE
LOUISIANA